



360 Camera Guide

realsee.ai



Capture Process Overview

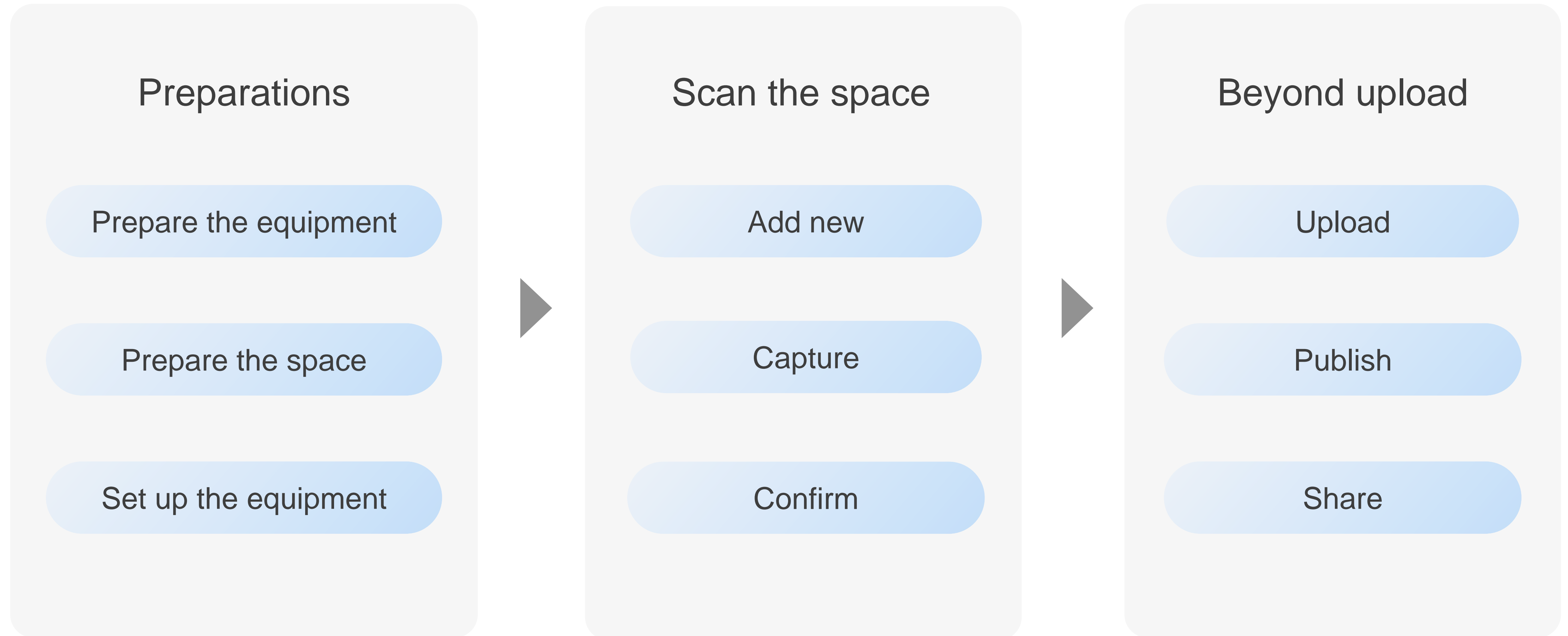

Preparations

- Prepare the equipment
- Prepare the space
- Set up the equipment

Preparations | Prepare the equipment



360 camera

Compatible with Ricoh
Theta Z1, V, SC2; Insta
360 One X
Keep lens clear



Smart phone

iPhone or Android devices



Tripod



APP

Realsee VR APP

Preparations | Prepare the space



Clean up the room



Turn on all lights



Open all doors

The narrow space needs to
open 45°

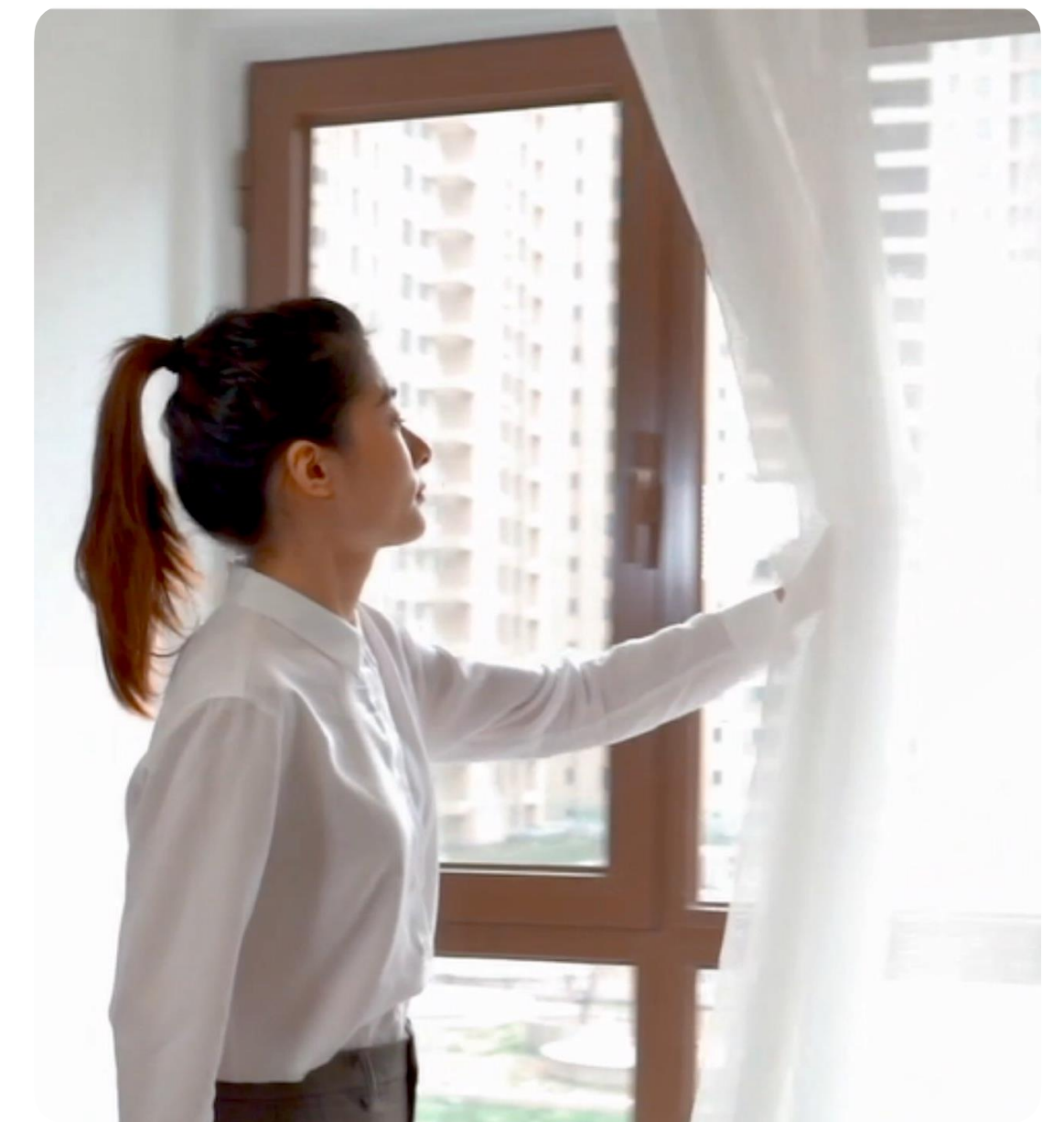

Open all the curtains

Tips: Pay attention to the storage of private items.

Preparations | Prepare the space

Plan the scanning path

- A common **first scan** location is the foyer. Or simply start from a relatively empty area.
- Move the whole set of device to the next scan point and scan in proper order.
- The distance between two sequential scan points should not exceed **2m**. Make sure there is a clear line of sight between the two points.
- Take scans just before the **threshold** and just after the threshold. Make sure users have a clear pathway. **See red circles.**

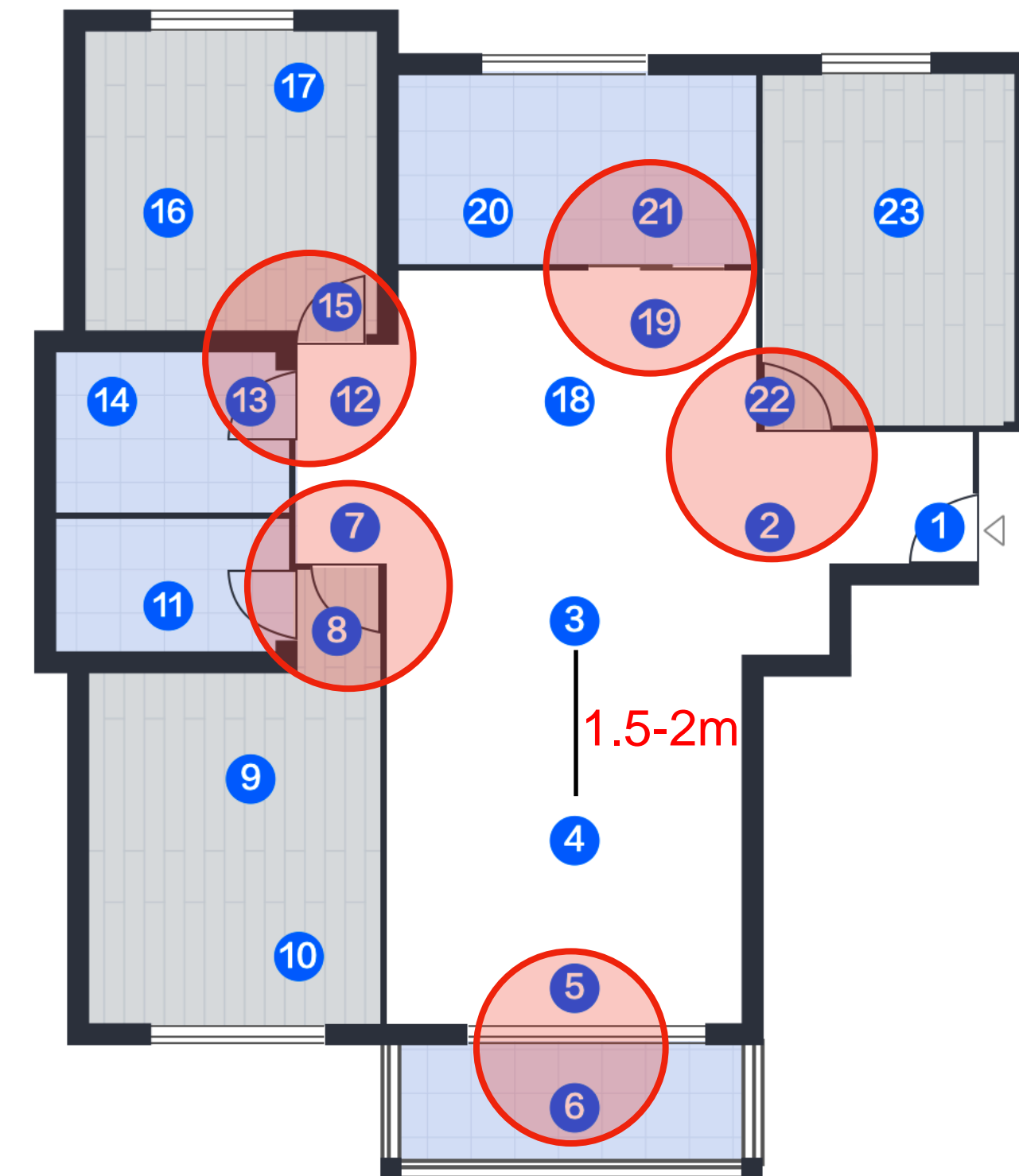

Preparations | Set up the equipment

- Set the [tripod to 1.4 meters](#);
- Make sure the tripod is stable.

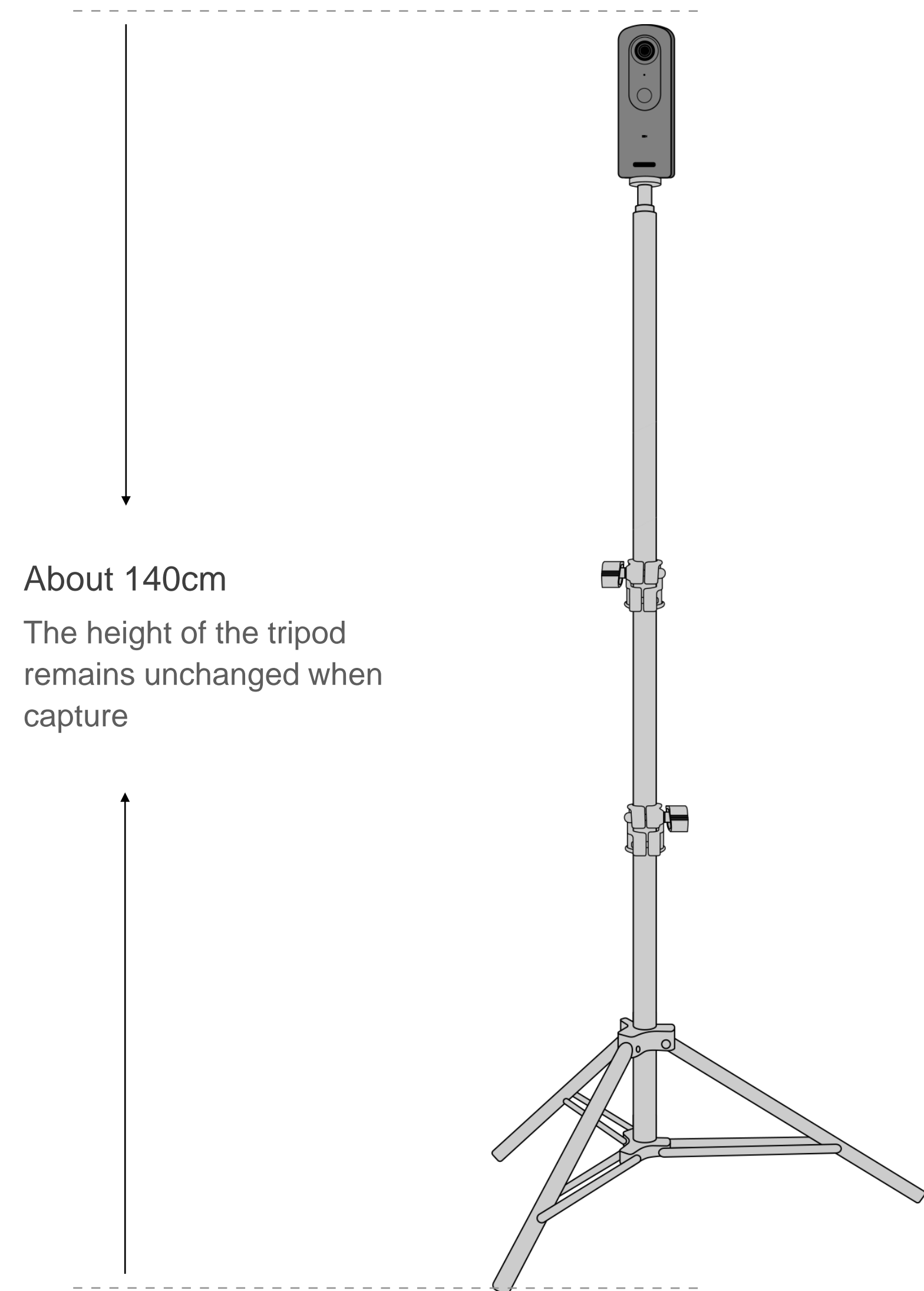

Preparations | Set up the equipment

Camera

- Hold down the power button (the top button) for three seconds

Power button
Wi-Fi button
Mode button



Preparations | Set up the equipment

Connect

- Open [[Settings](#)] on your phone and connect to the camera Wi-Fi.
- Find Wi-Fi that starts with “**THETA**” and connect to it.
- Password: all the digits in the name of the Wi-Fi. **Numbers only.**
- Take THETA 360 camera as example:

The Wi-Fi is as shown below, so the password is 11100735.

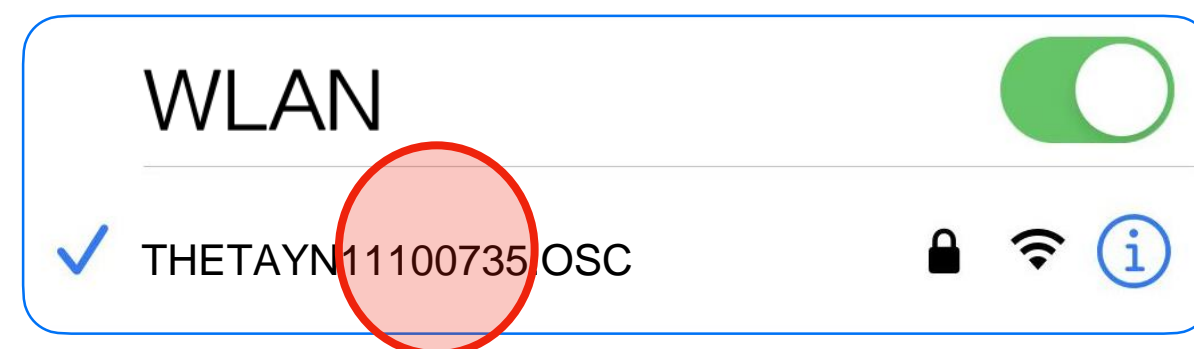

Wi-Fi name showing a check mark and Wi-Fi symbol no longer blinking mean that equipment is successfully connected.

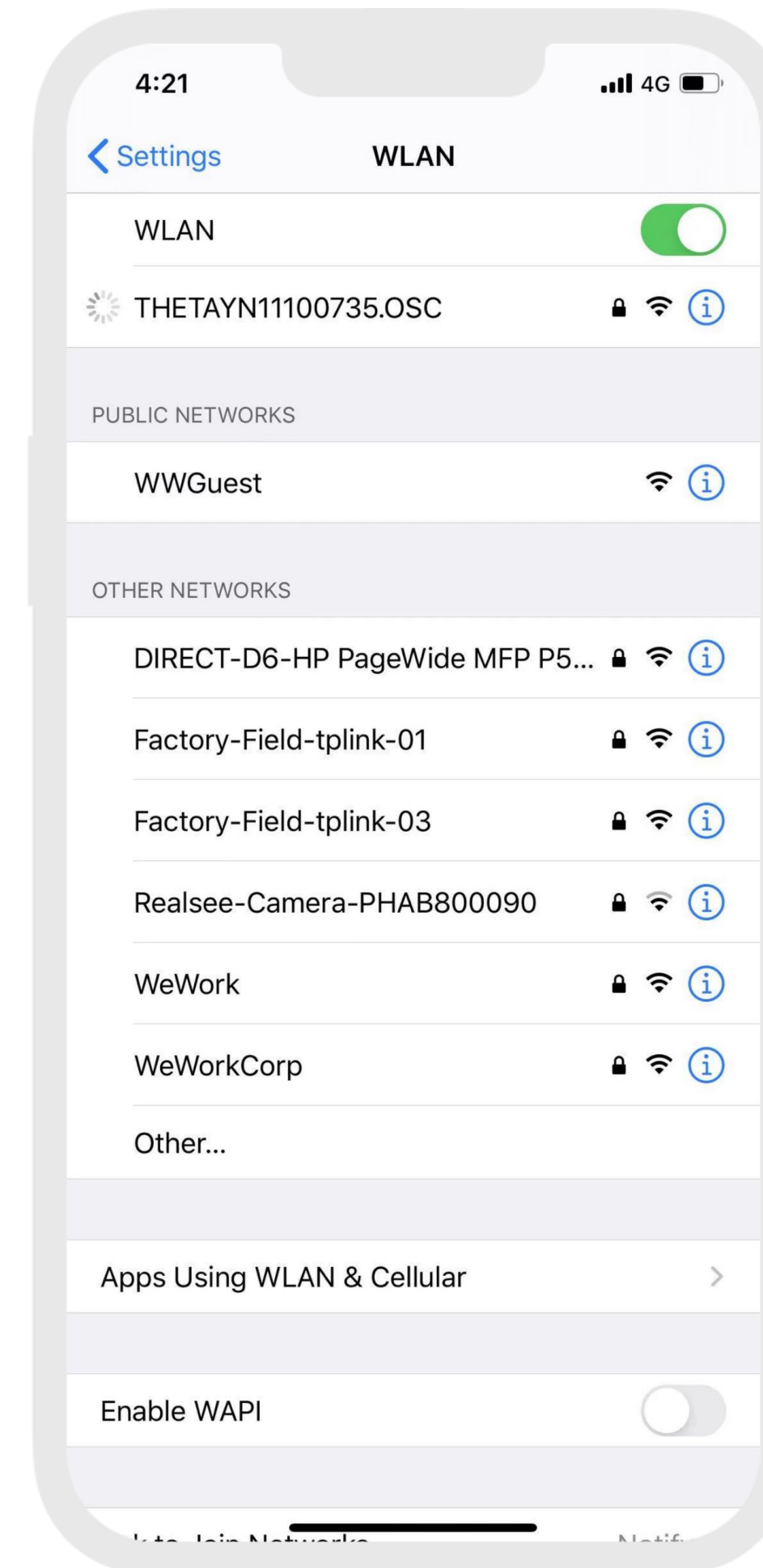

Scan the space

- Add a new tour
- Capture
- Confirm and upload

Scan the space | Add a new tour

- Login to the Realsee App
- **Switch identity.** Choose the organization you are working for.

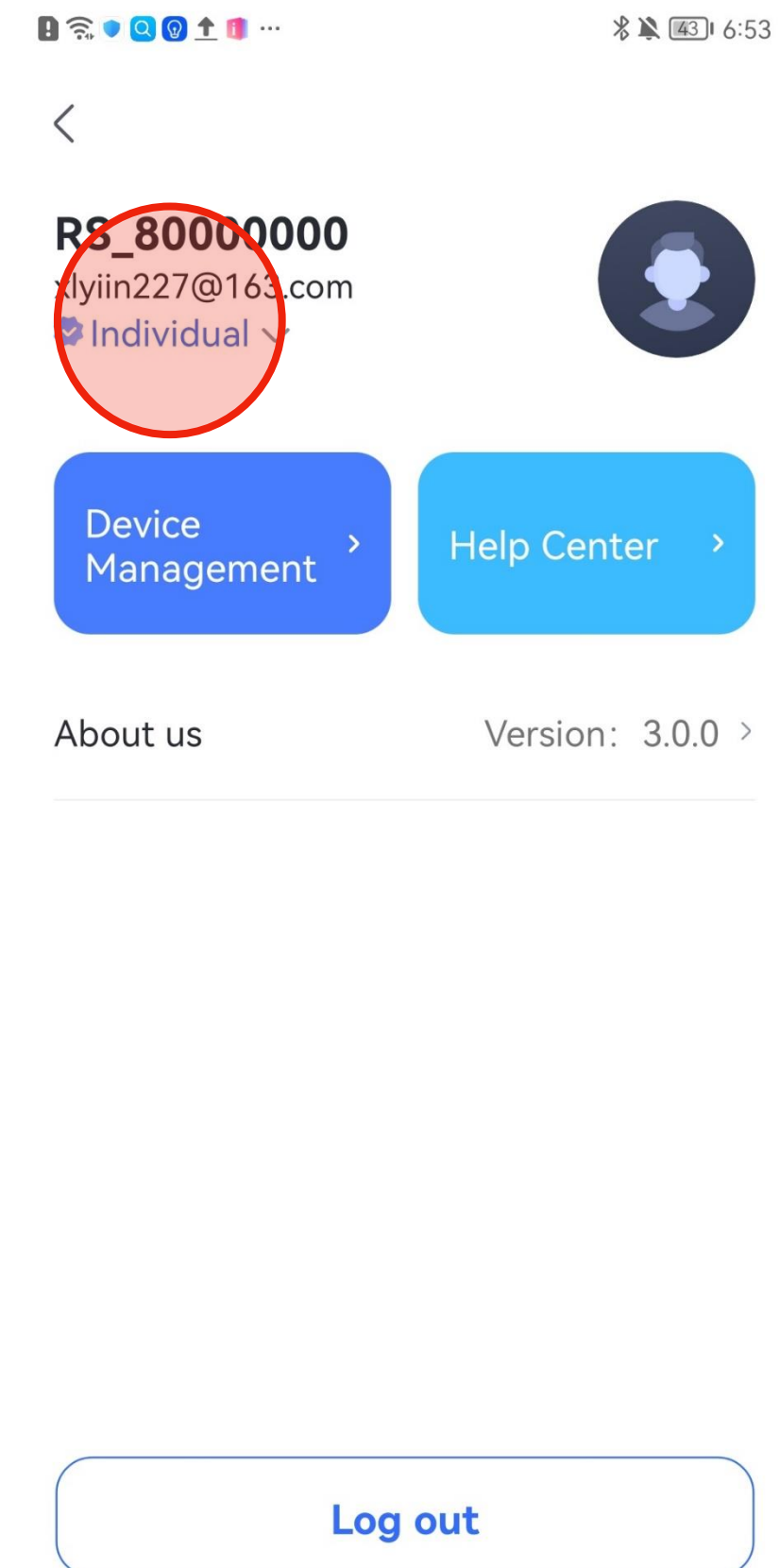

Scan the space | Connection

- Check if 360 camera connects successfully with your phone, your phone with local network.

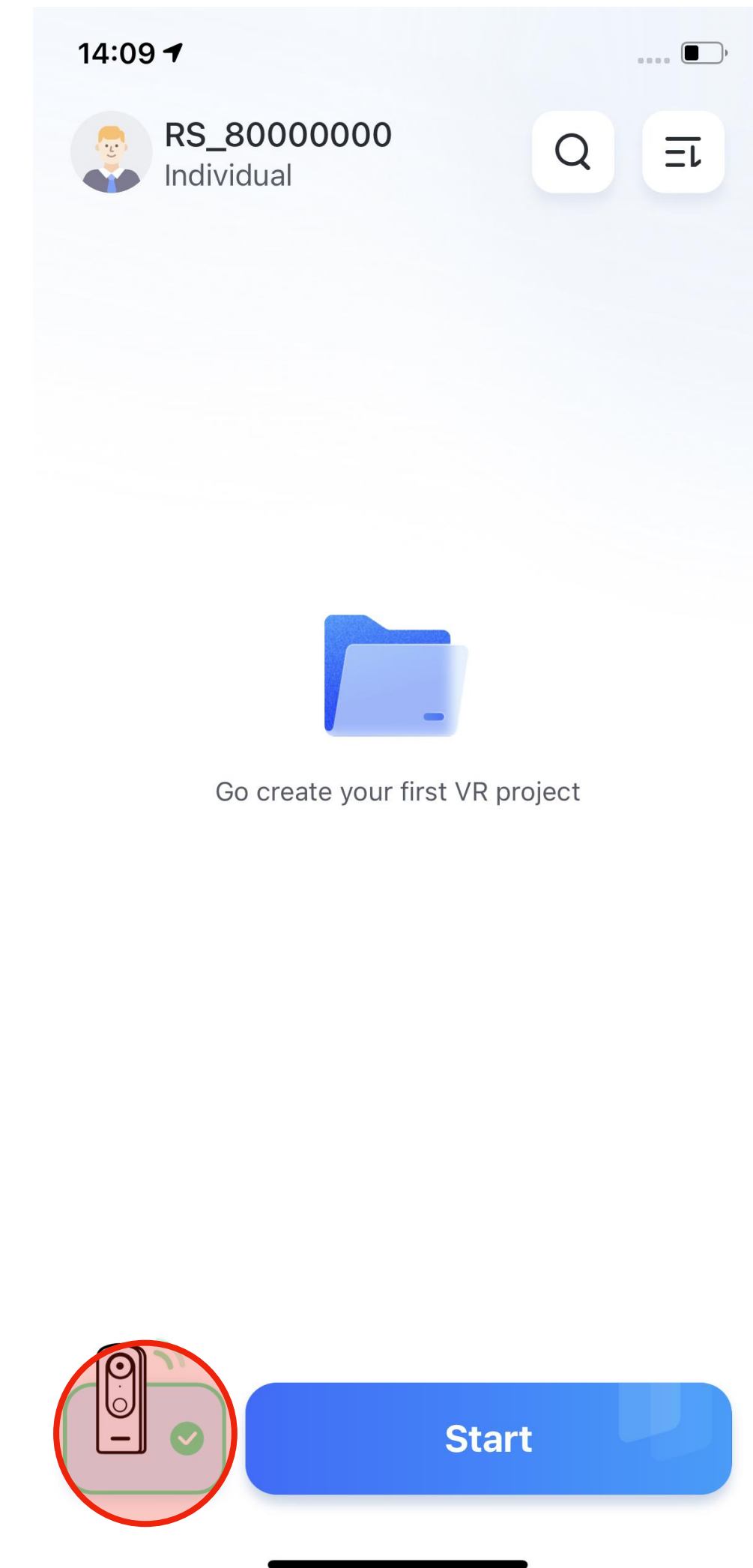
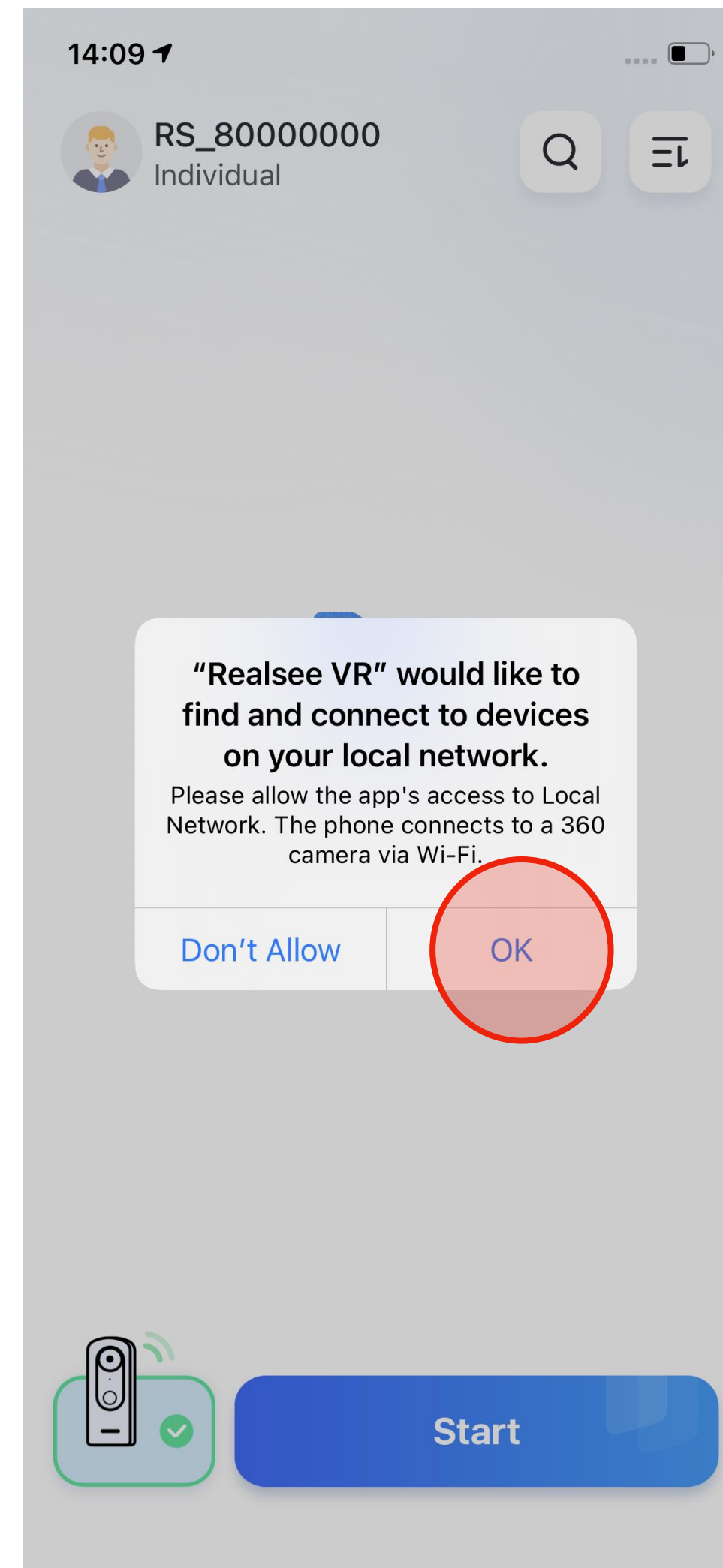

Scan the space | Capture

1、 Select floor

2、 Settings

- Timer
- Lighting

3、 Capture

4、 Alignment

- Each scan
- Whole floor

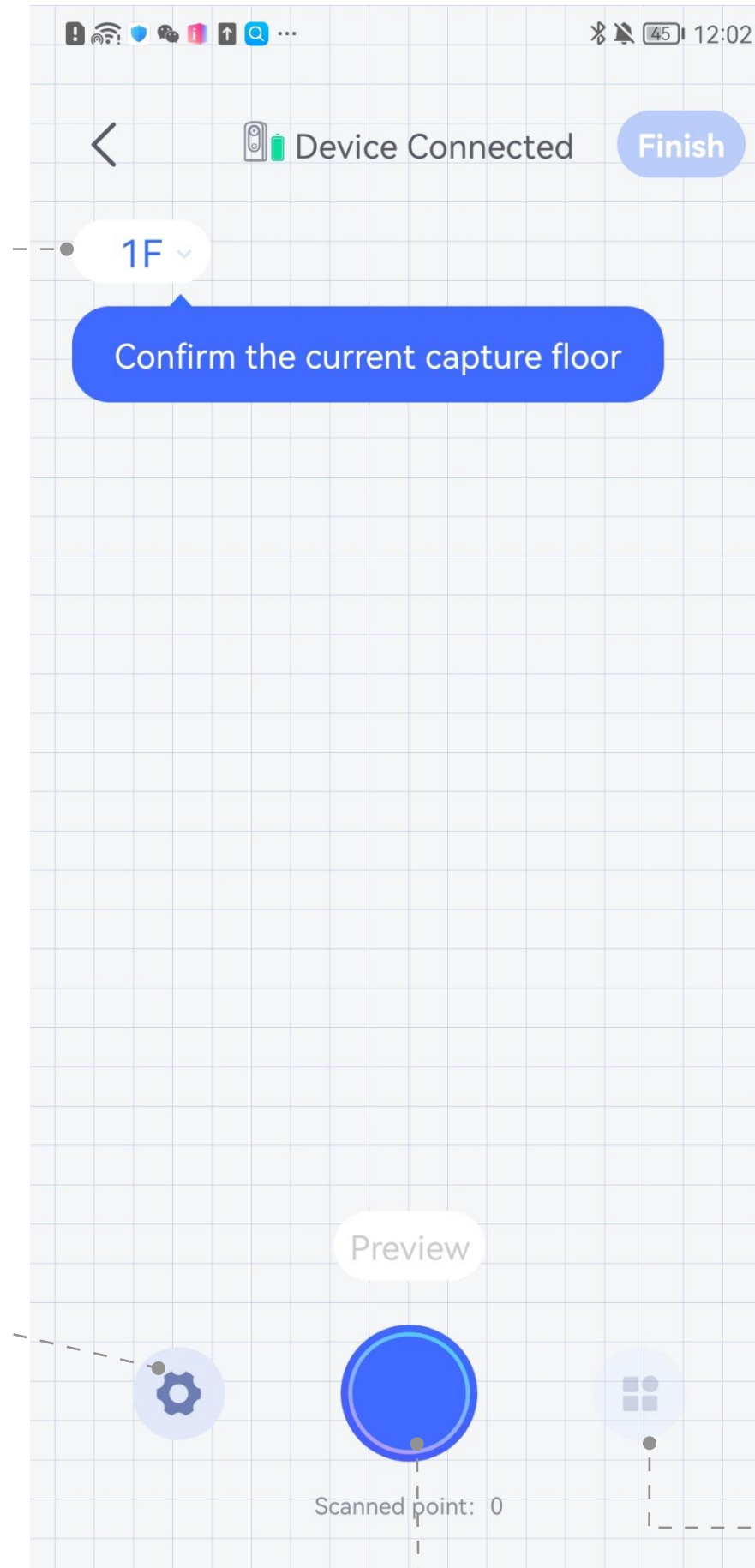

Scan the space | Capture

Lighting settings

- Switch lighting mode to cope with actual lighting condition.
- When it's too dark in the room, use "dark".
- When it's too bright in the room, use "bright".
- You can switch this setting at [each shooting point](#) if needed.

Timer settings

- Tap to capture and hide yourself out of the scan radius within countdown.
- Choose 5, 10, or 15 according to seek-to-hide time.

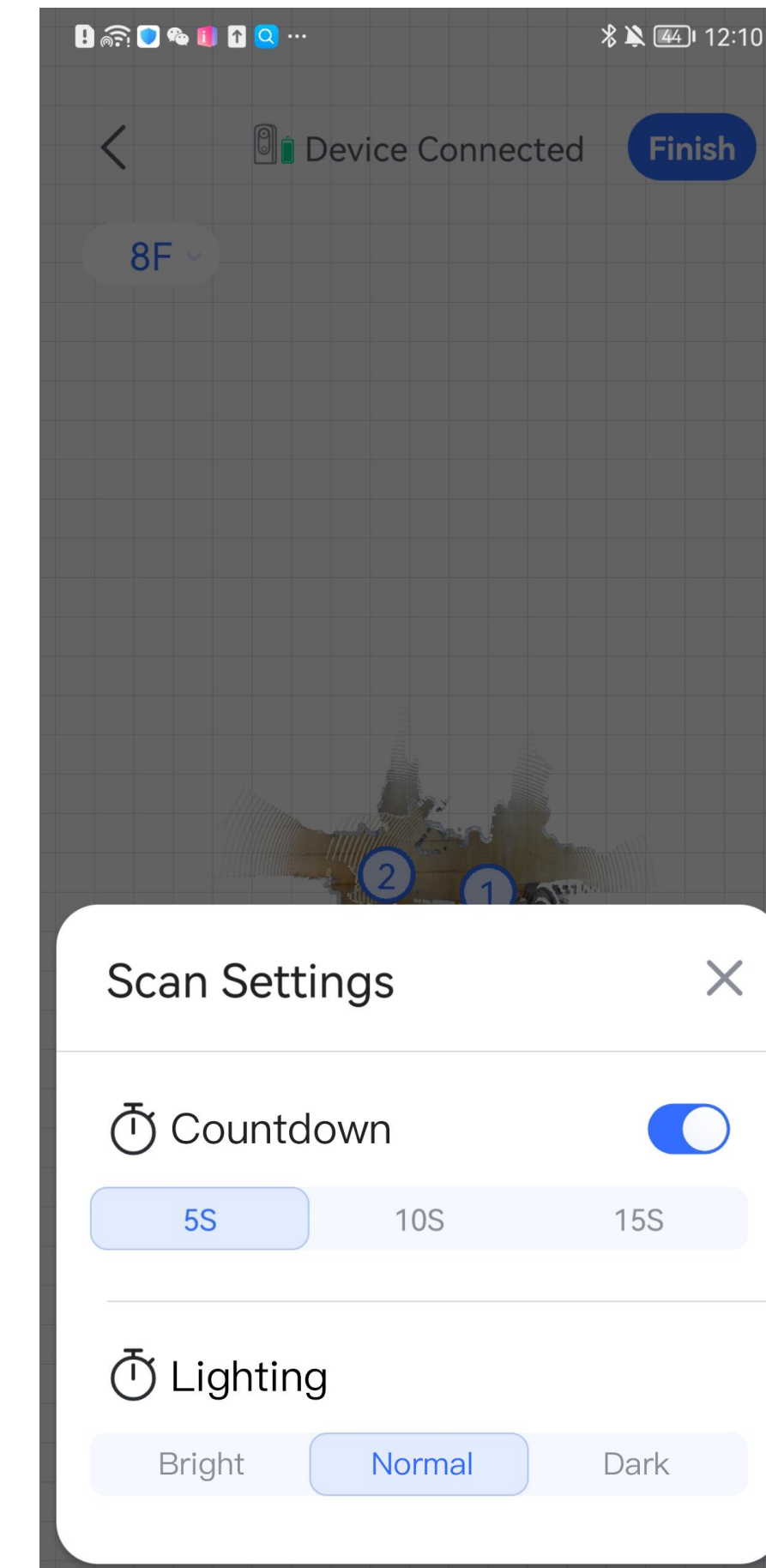

Scan the space | Capture

Capture and preview

- Then you'll see the top-down view of the scan with the scan's sequence number displayed.
- Move to the next scan point.
- Scan the whole space according to your path plan.
- Pay attention to the notes in "Plan the scanning path" (Page 6) if you are new to Realsee VR.

Note:

- The preview does not represent the final quality.
- You may tap on the sequence number of any scan to preview the panorama. You may also delete this scan or align the scan with other scans.

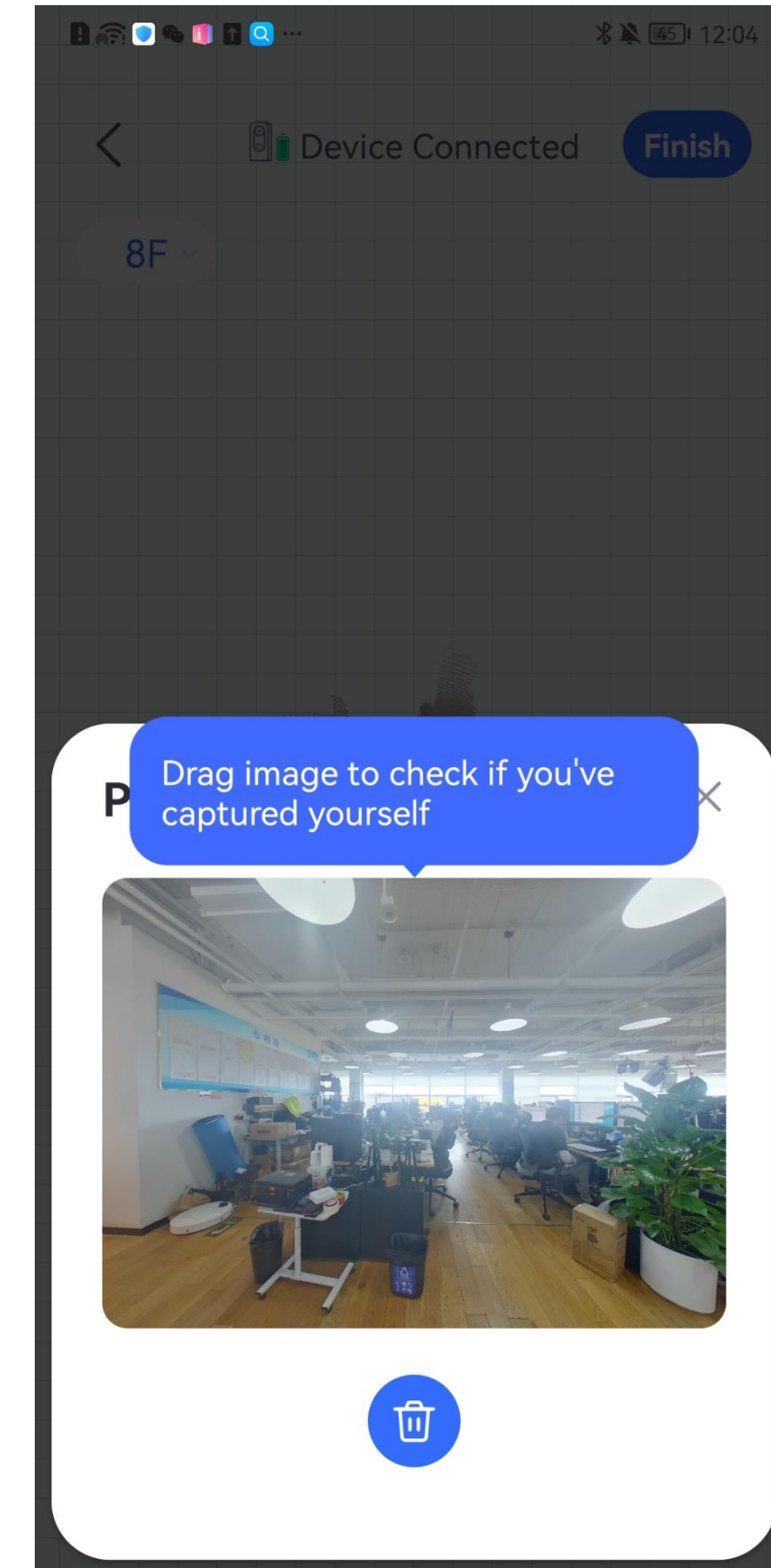
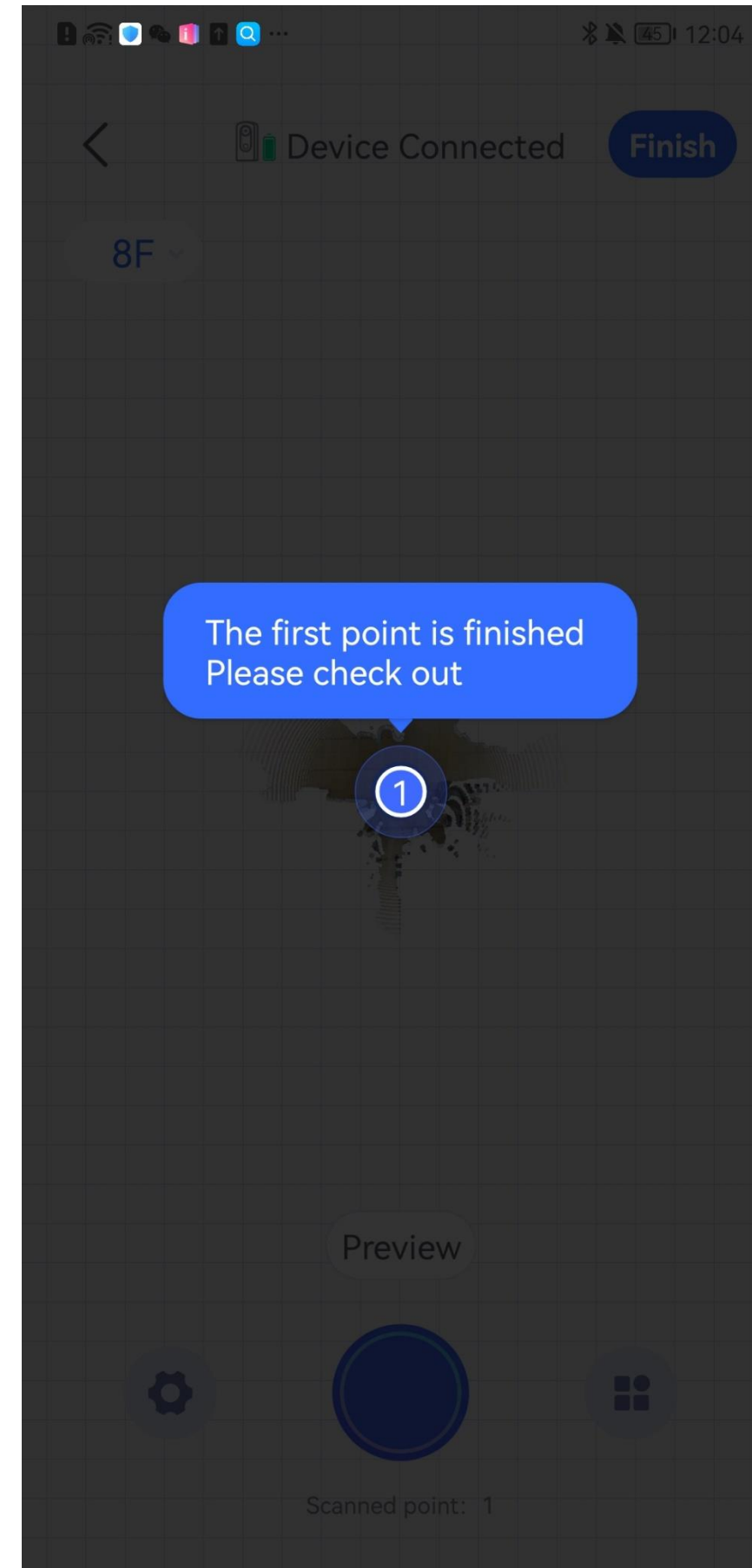

Scan the space | Confirm and name

- After you've finished scanning, check whether the outline of the scans conforms to the house layout.
- If there's no problem with your points captured, press 'finish'.

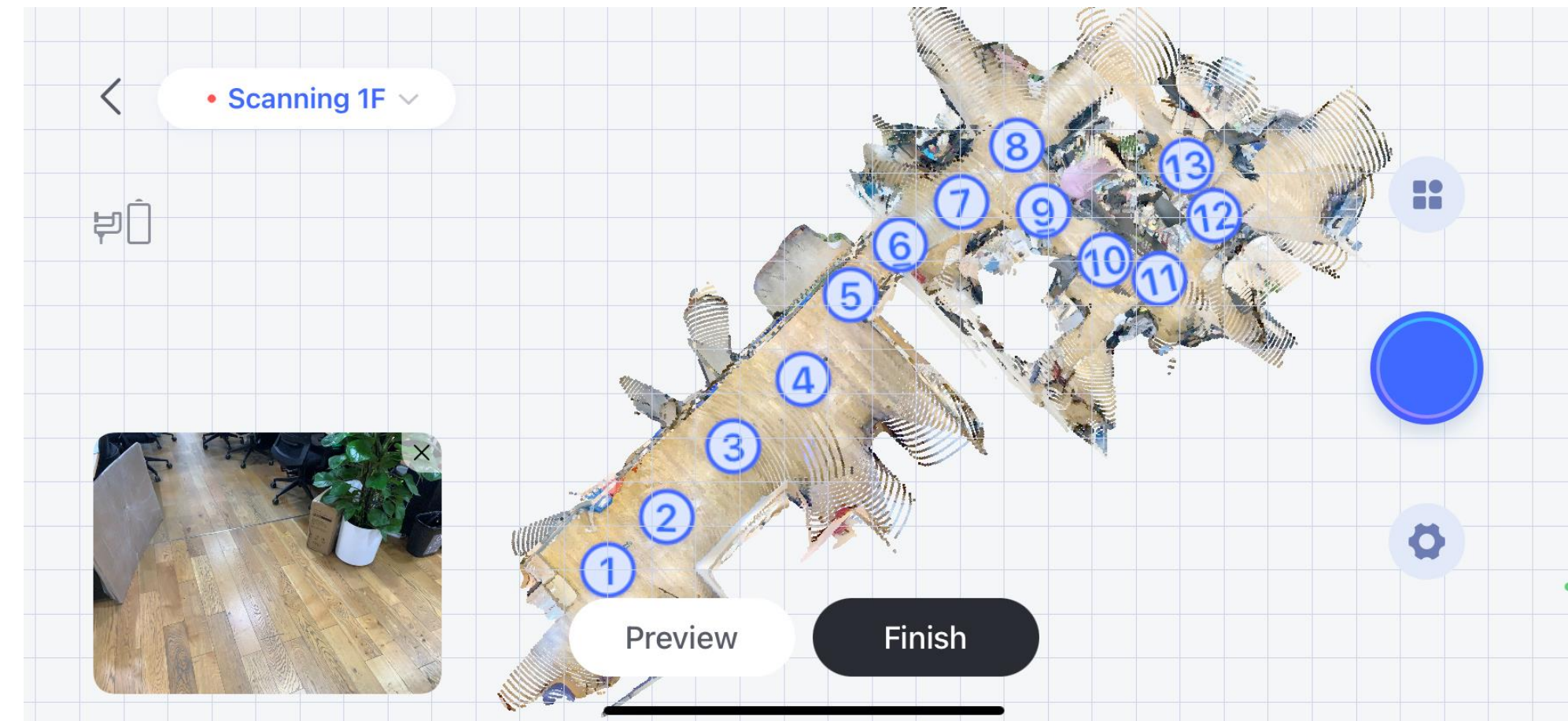

Scan the space | Confirm and name

- After confirming, name your projects and press 'Generate VR'
- Remember switch your network connection from 360 camera to your public Wi-Fi or 4G.



Beyond upload

- Upload the tour
- Publish the tour
- Share the tour

Beyond upload | Upload the tour

Ensure that the network is stable during uploading.

After uploading, you can close the app and wait for the project to be processed

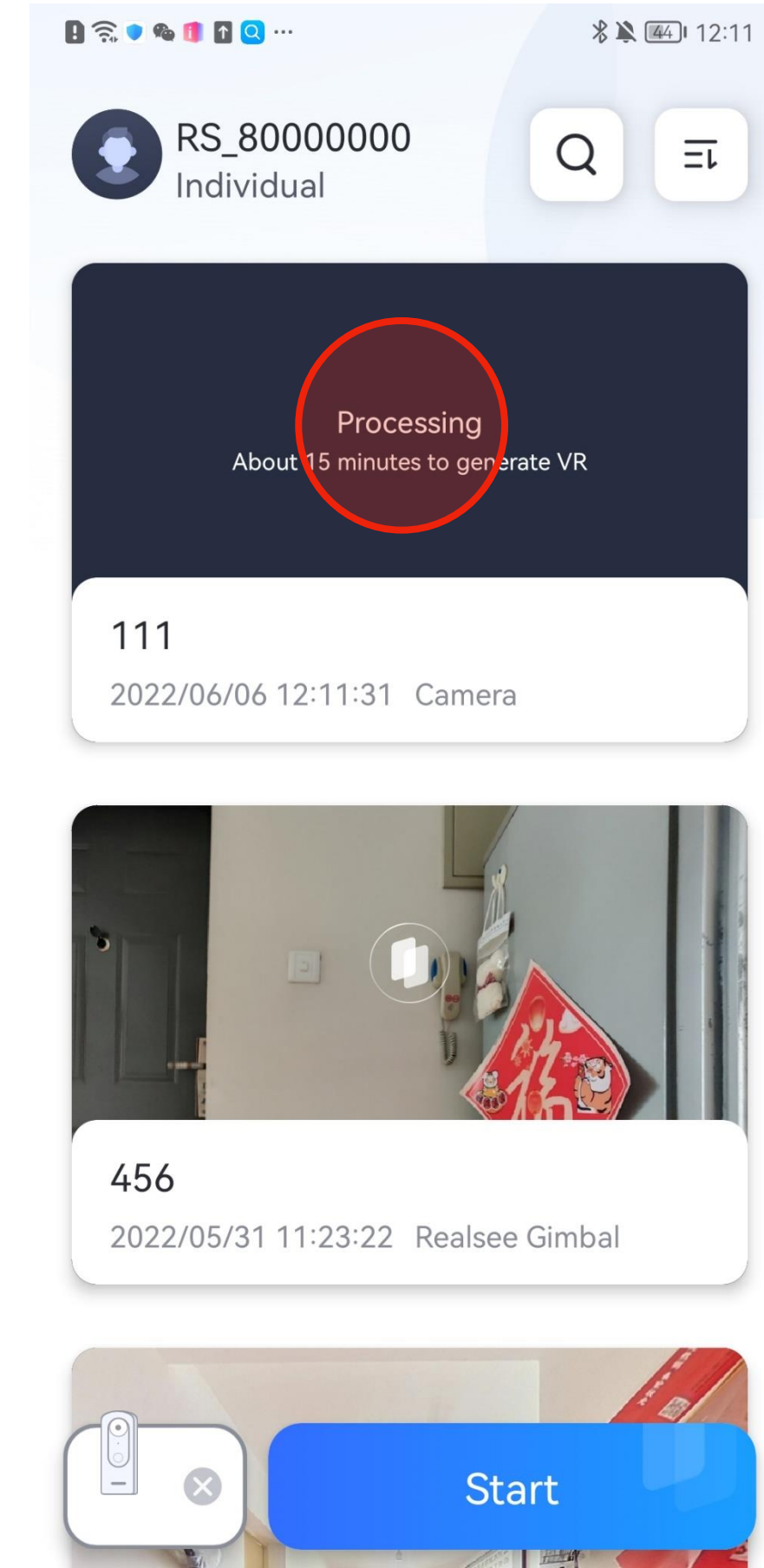
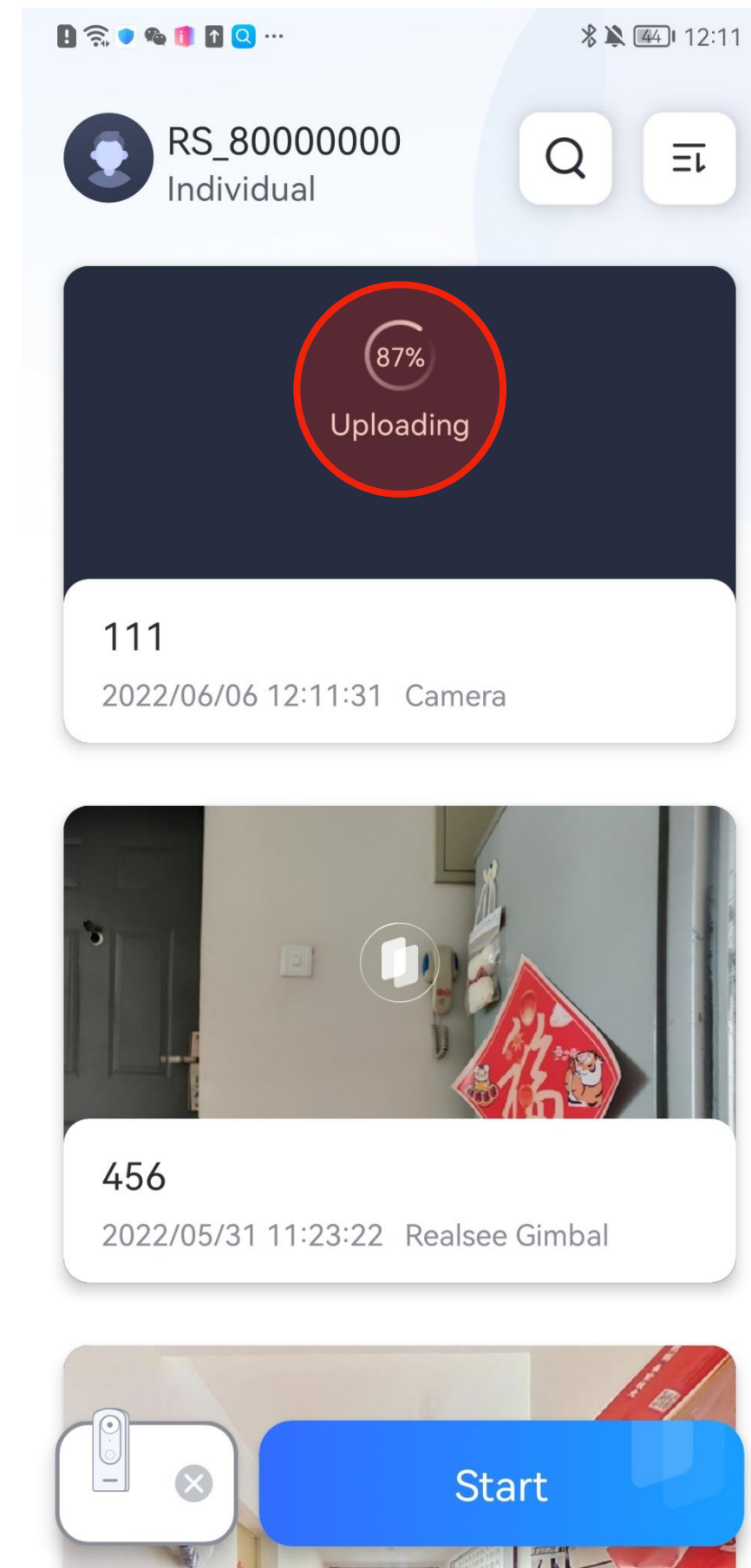

Beyond upload | Publish the tour

You can edit your project through your REALSEE VR APP.

To manage all your tours in front of PC, you can access to:

<https://new-workshop.realsee.jp/>

More details about PC version workshop, please refer to workshop guide.

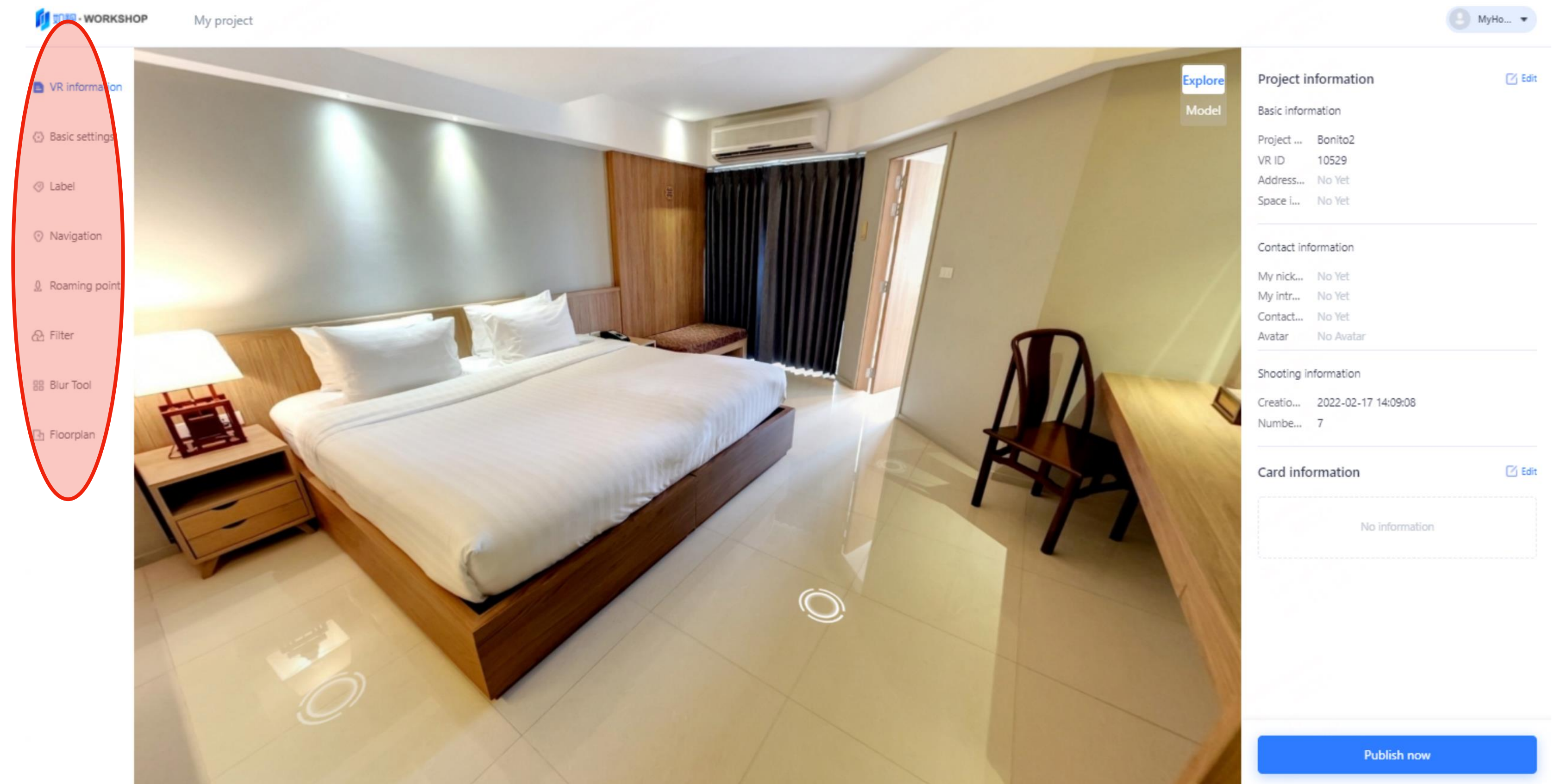

Beyond upload | Share the tour

You can get the URL of your virtual tour from app or workshop and share it to social media or embed it on any website or app.



Tips

- Compass
- Complex scenario path plan
- Scan misaligned
- Align floors
- Fix the model

Tips

Compass

- Open Compass
- Take a screenshot
- Edit the entrance door in Workshop
- Get interactive NSEW direction when viewing

Upon arrival, open Compass on the phone. Stay inside the property behind the entrance door.

Place your phone against the wall like in the picture. Take a screenshot of the current direction number indicated by the Compass.

Later you can set the parameters for the entrance door in Realsee Workshop.

Enter the number you got from the screenshot and then the tour will have the interactive orientation.



Tips

| Prepare the space

Plan the scanning path

A more complex scenario

- Make sure that all the space to be scanned is accessible.
- For **narrow and long** aisles, you can shorten the distance between scan points. See Point 24,25,32; and Point 15,14,13,12,11
- Scan **outdoor** or **balcony** at last.
- In **narrow areas** where the door is set at 45-degree angle, make sure there is clear line of sight. Scan before and behind the door. See Point 14, 15, 16.

For empty rooms, take 1 or 2 points.

For rooms with furnishings that may draw interest, take scans near the **point of interest** to better display the features.

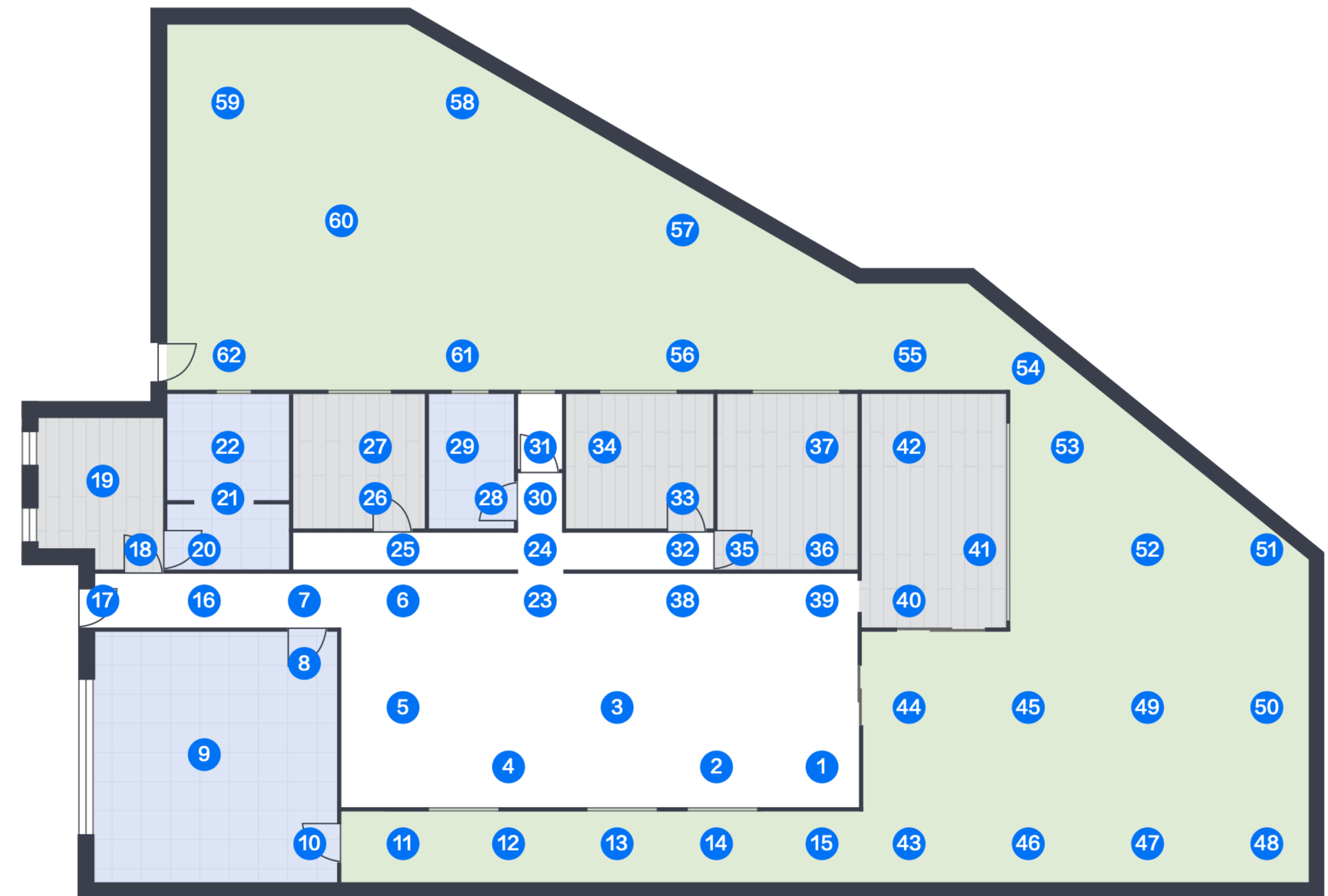

Tips

| Align

Scan misaligned

This process is only necessary if you find your scan(s) in the top-down pane offset from your actual shooting position.

- When a spot is offset, you need to:
- Select the Manual Splicing– Check mark-- Drag and/or Rotate it to the correct location.
- Use the features in the top-down view to help you.
- You may do it at any moment before you upload the tour.

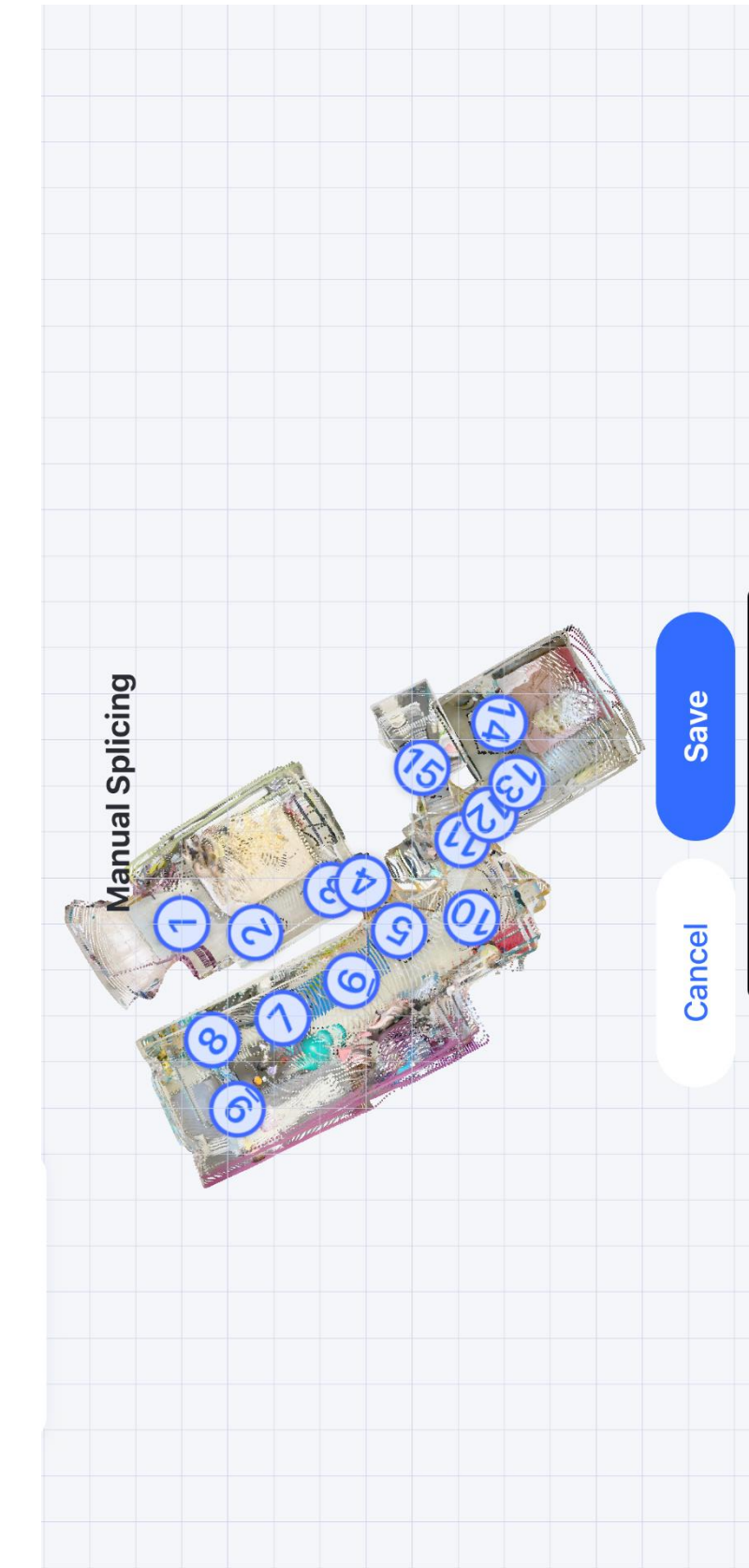
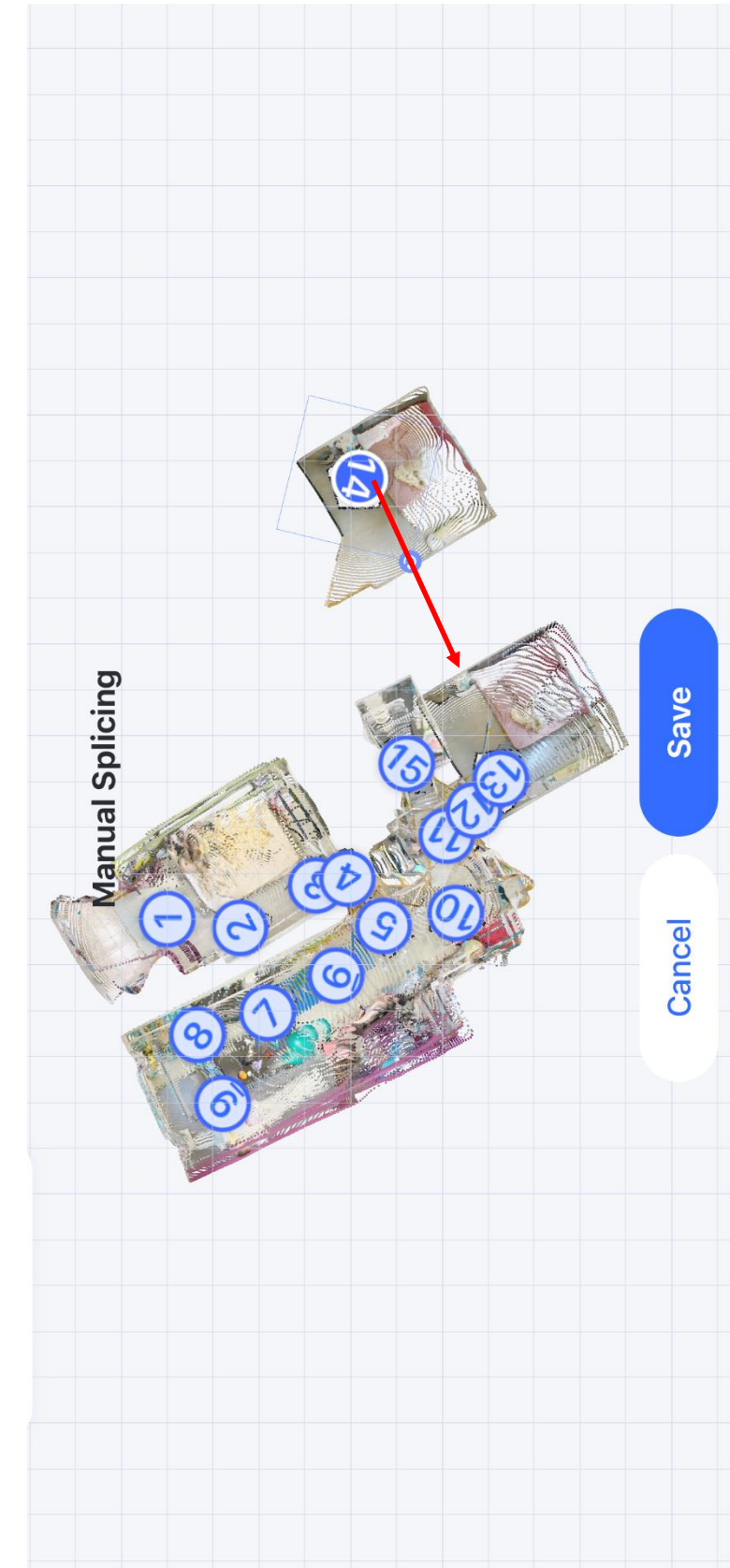

Tips

| Align floors

Align all spots on the same floors simultaneously



Tips

Fix the model

For unpublished tours

When the scan points on the phone are perfectly located but the tour generated has errors, such as two rooms are stitched into one room, then “Model Fixing” is a smart button to rerun the project and fix the error.

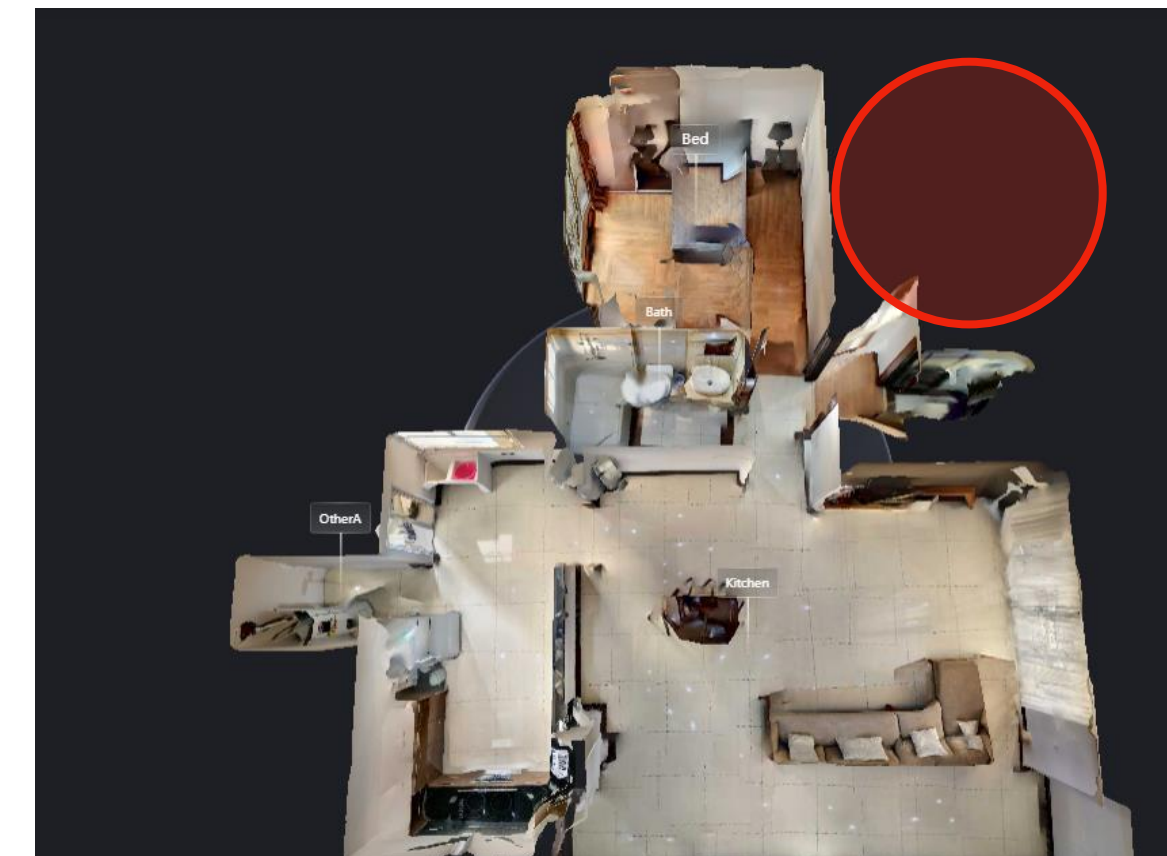
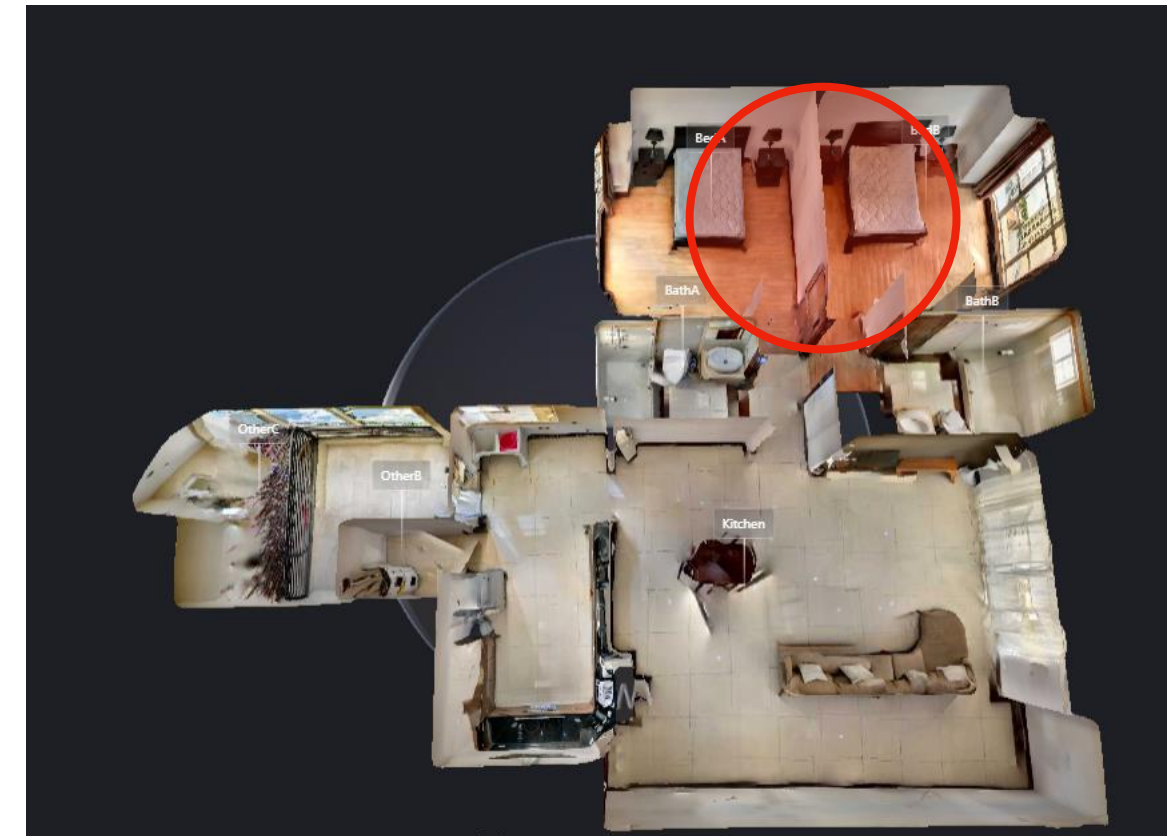

Example: two similar rooms are stitched into one

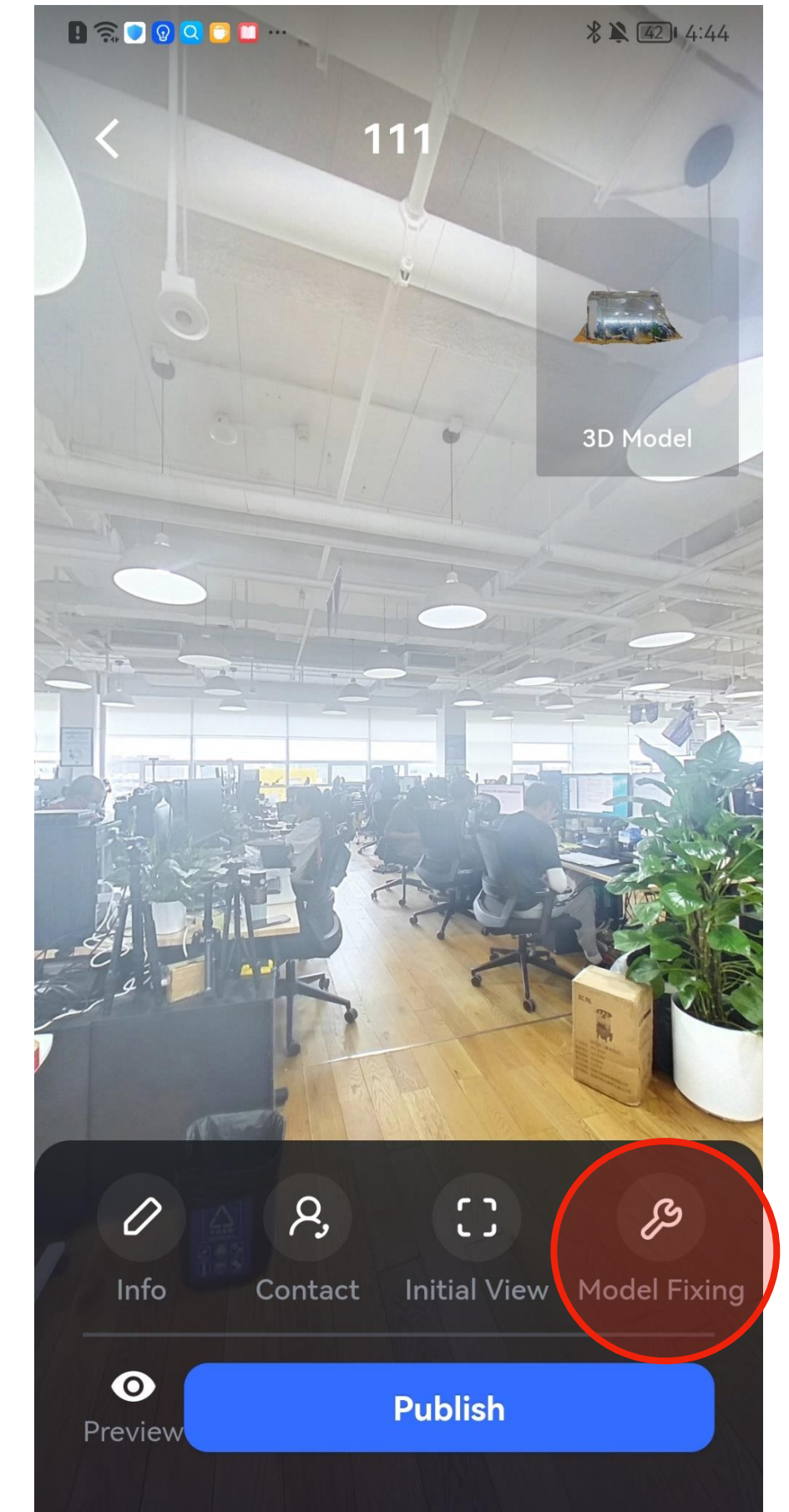

Capture Process Recap

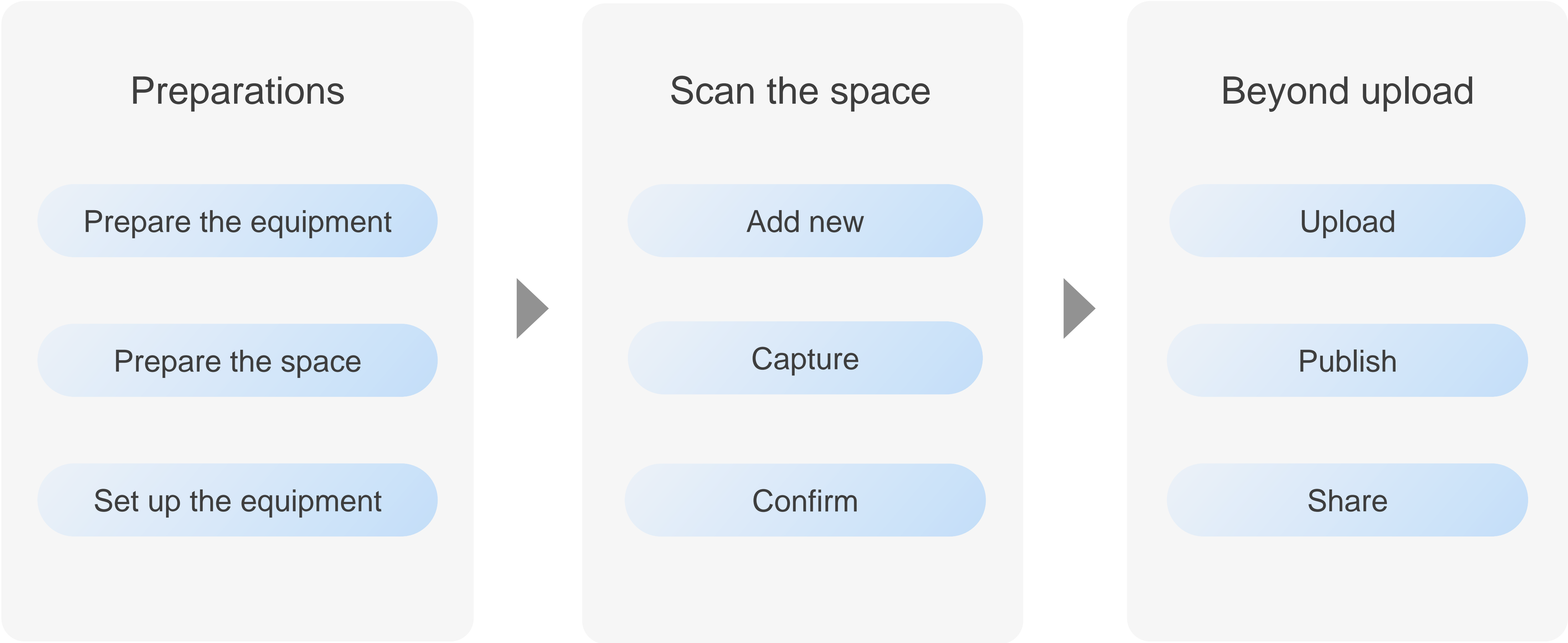



Thanks