



REALSEE G1 Guide

realsee.ai



Products

Realsee's next generation Gimbal puts the power of AI and VR in the hands of everyday brokers. No professional equipment or training required – simply plug and play.

- Mobile integrated VR solution
- No barrier to entry, lock in and capture
- Enhanced by AI, bring listings to life



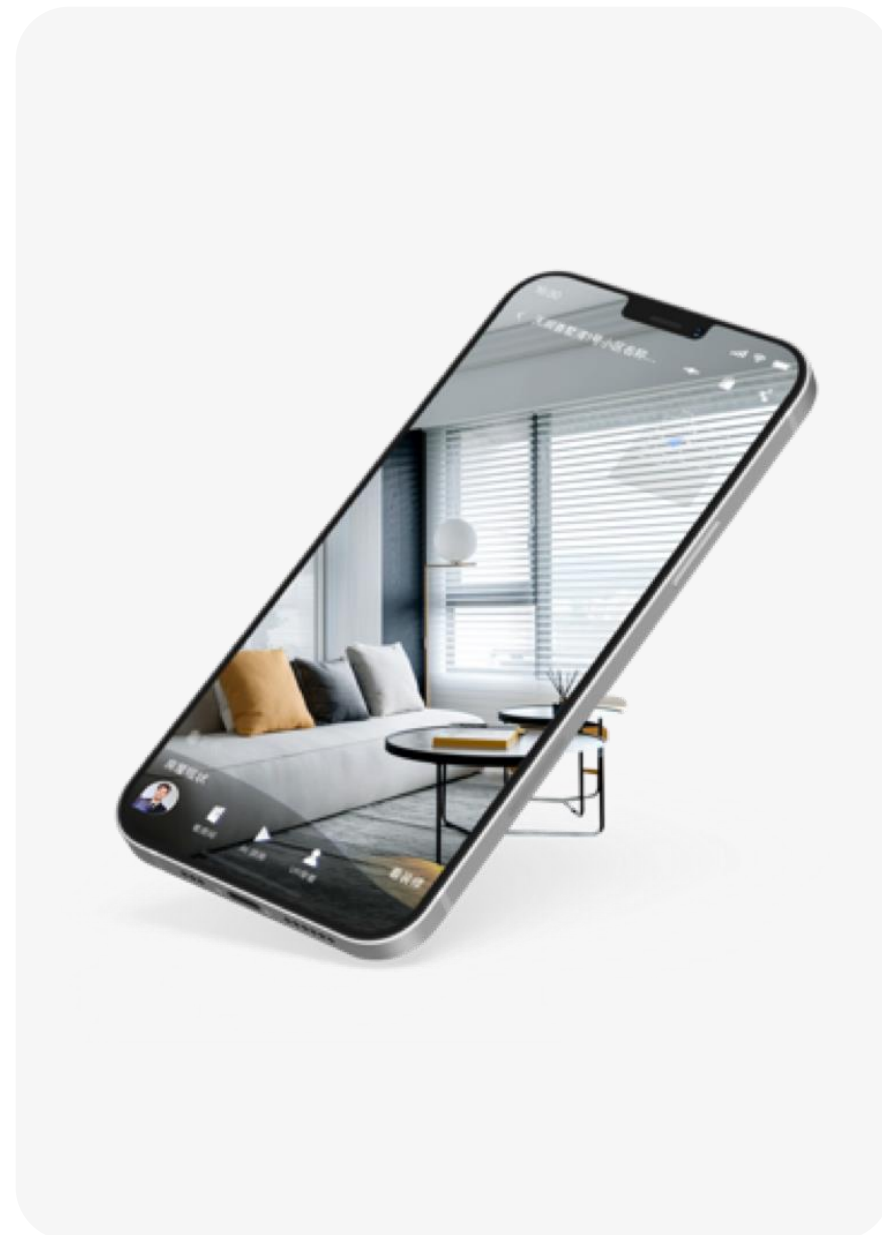

VR Property Tour

- View listings anywhere, anytime
- Lifelike 1:1 3D reconstruction
- View through any device

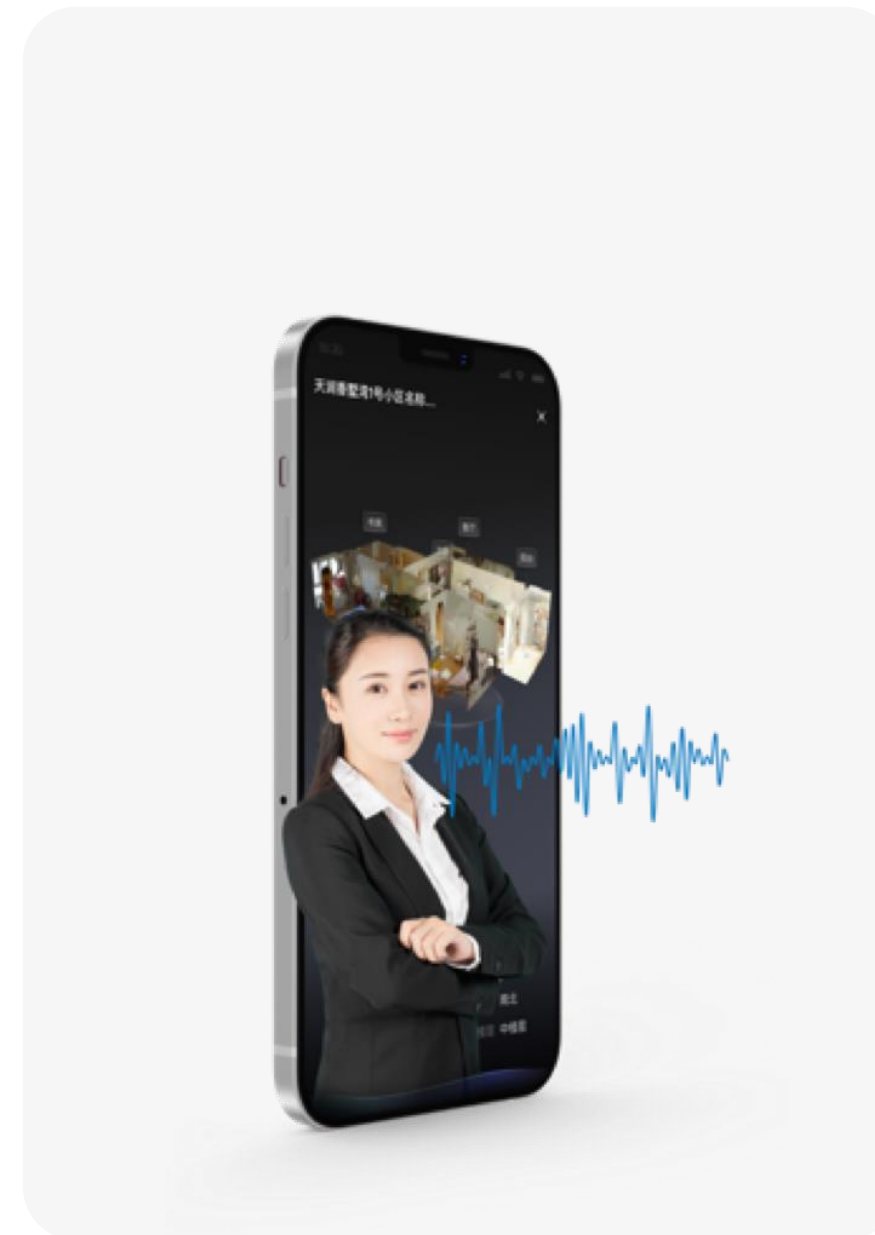

VR Property Walkthrough

- Pre-recorded listing overview
- Explore and listen at the same time
- Save time and serve more clients

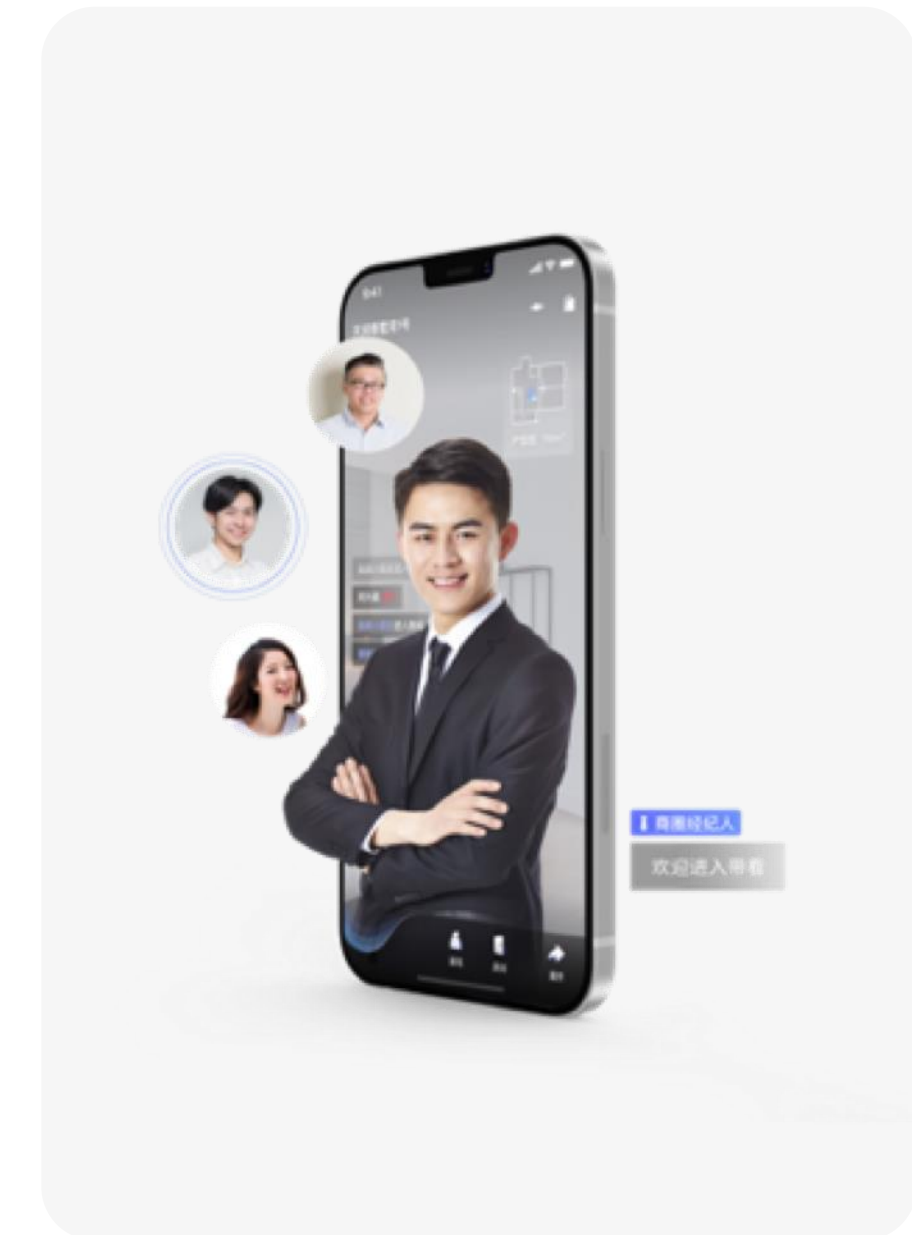

VR Property Inspection

- Be in the virtual room with client
- Multiparty online interaction
- Generate better leads and sales

01. Setting Up

Prepare the Device

Prepare the Room

Set up the device



02. Capturing a Space

Add new

Capture

Upload



03. Editing

Publish

Enrich

Share

01.Setting Up

- Prepare the Equipment
- Prepare the room for shooting
- Setting up the device

Setting Up | Prepare the Equipment



Realsee Gimbal

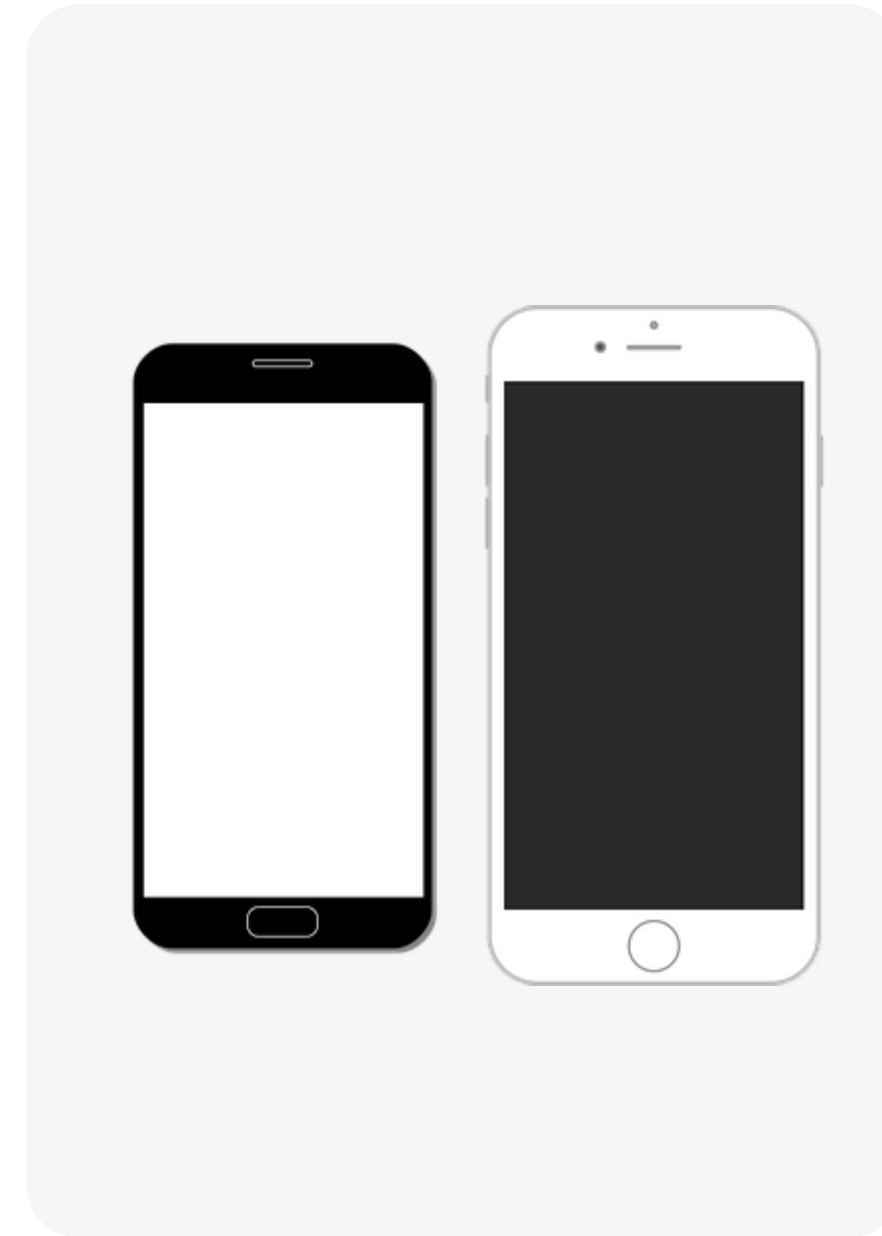

Mobile phone



Tripod
1.3 meters high

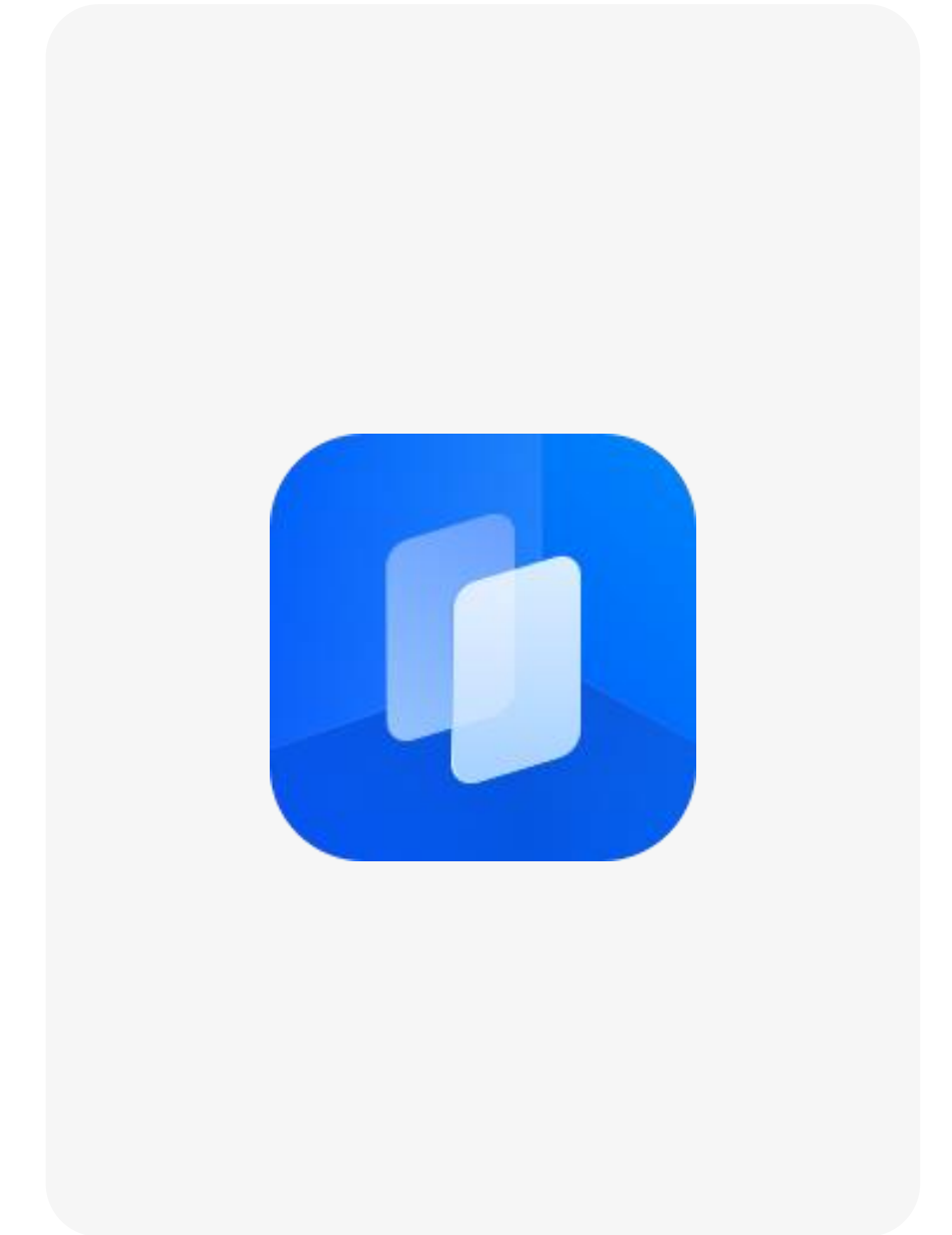

APP
Realsee VR APP

Setting Up | Prepare the Equipment



Clean up the room



Turn on all lights



Open all doors

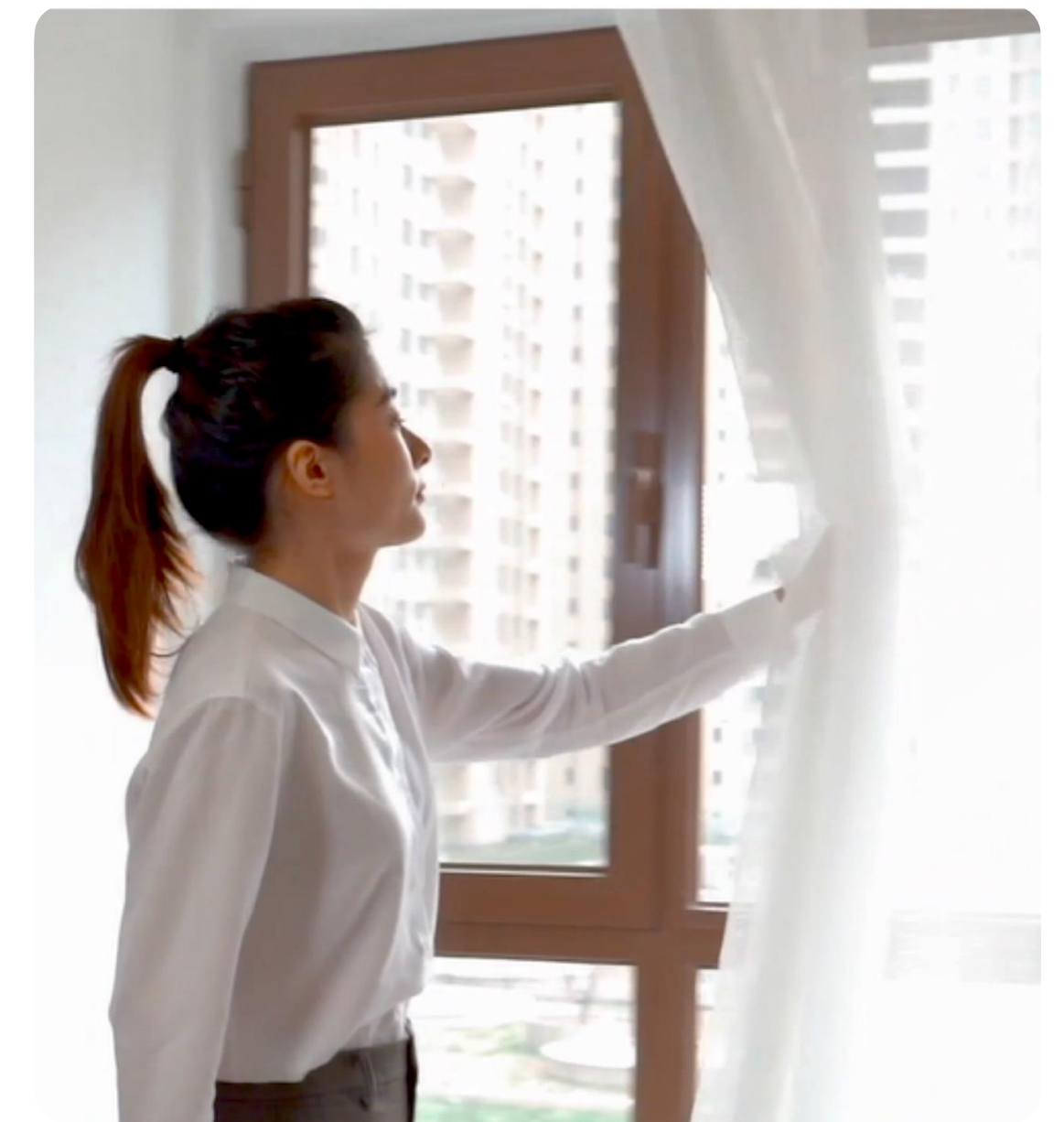

Open all the curtains

Tips: Pay attention to the storage of private items.

Preparations | Prepare the space

Plan the scanning path

- A common **first scan** location is the foyer. Or simply start from a relatively empty area.
- Move the whole set of device to the next scan point and scan in proper order.
- The distance between two sequential scan points should not exceed **2m**. Make sure there is a clear line of sight between the two points.
- Take scans just before the **threshold** and just after the threshold. Make sure users have a clear pathway. **See red circles.**

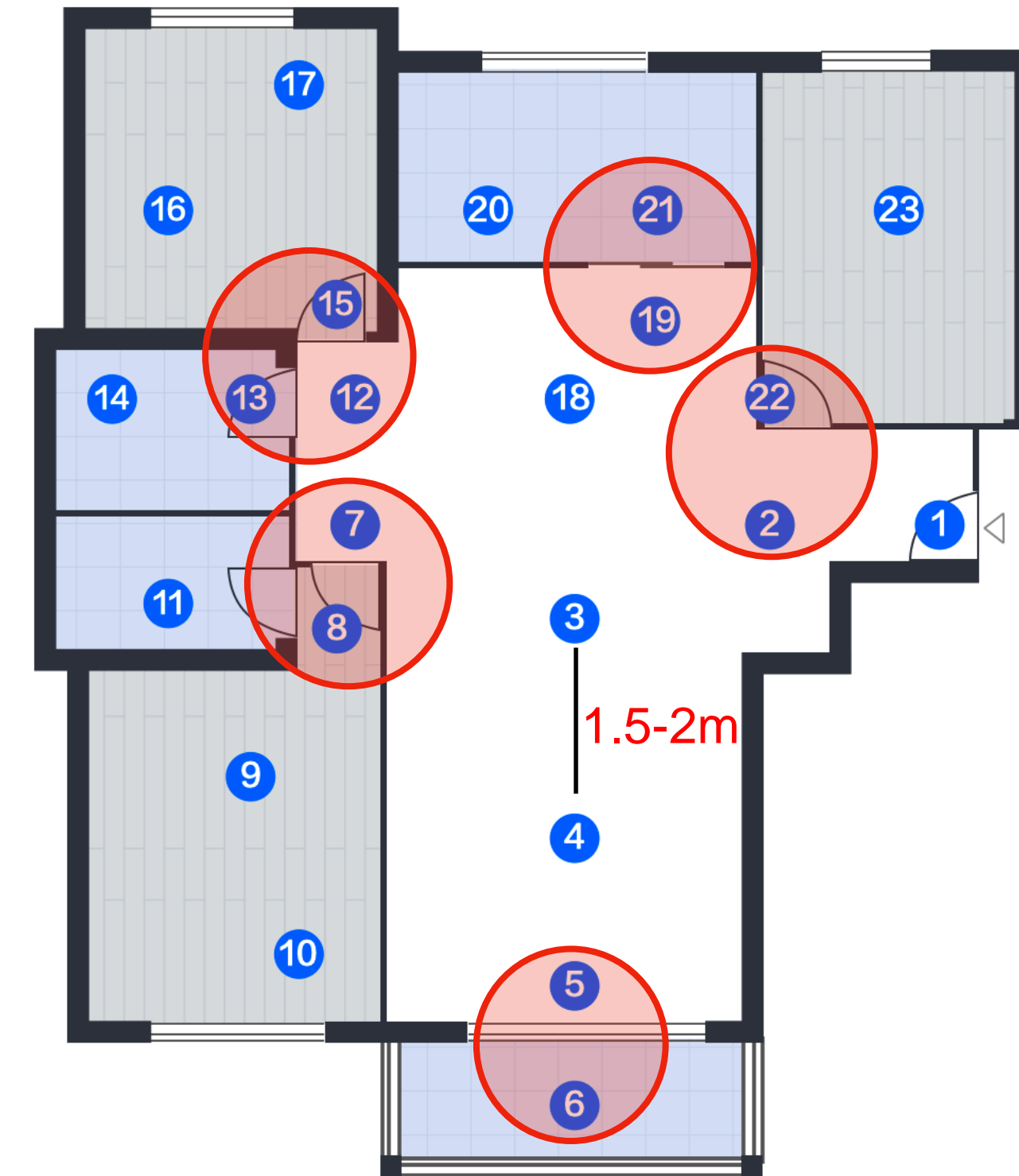

Setting Up | Setting up the device

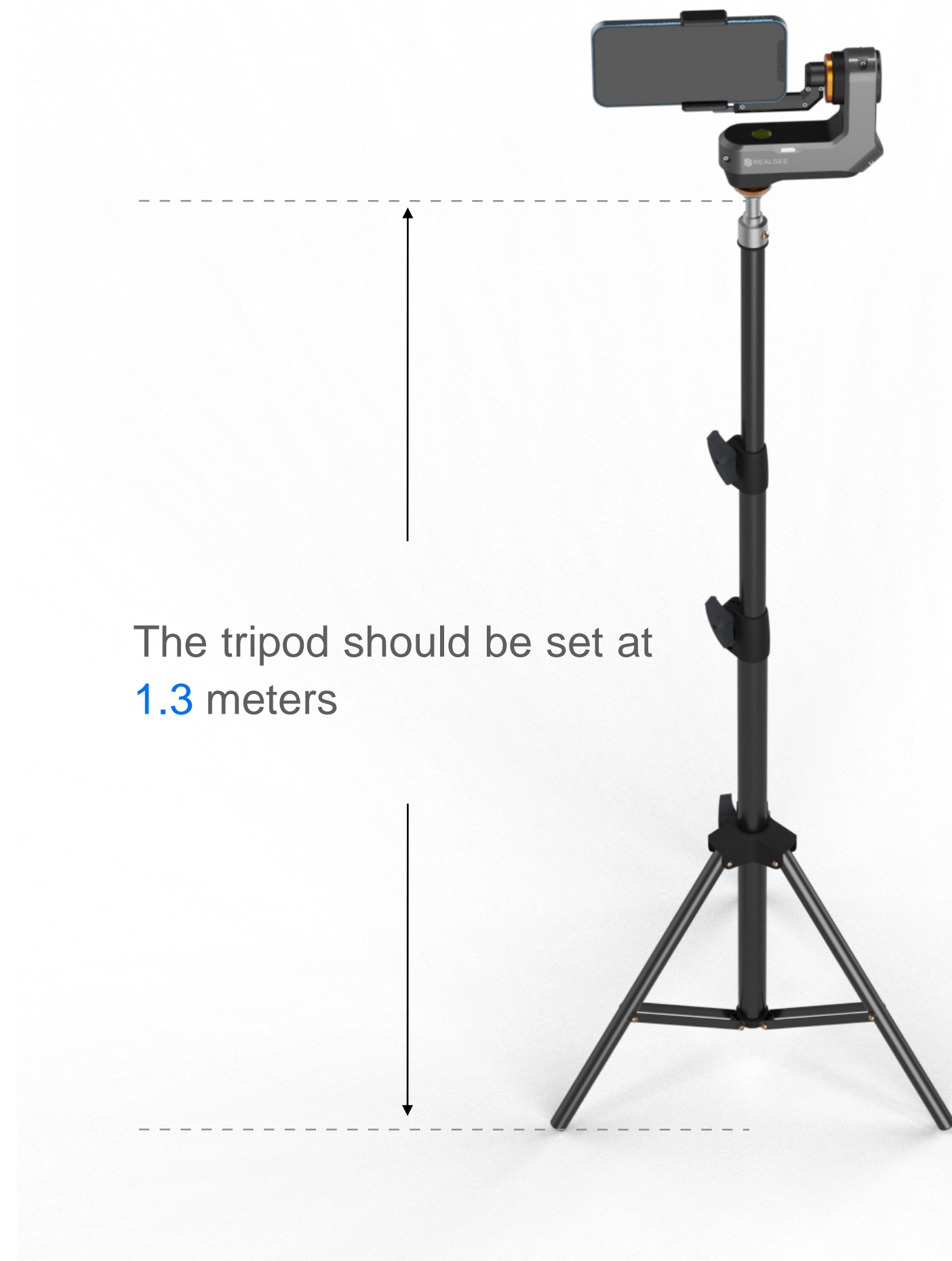

When clipping in your phone to the frame, the main camera should line up with the **small red dots** visible on the device

Affix the frame to tripod using the frame's gold colored base and **rotating in a clockwise** direction until frame is firmly in place

Setting Up | Setting up the device(cont.)



- Green light: Full battery
- Red light: Low battery
- Blue light: Bluetooth connection
- Yellow light: Power off charging (steady on means)

02.Scan the Space

- Add new
- Capture
- Upload

Scan the Space | Login

- Register your Realsee account with an email address. (Sign up)
- Log in. (Sign in)
- **Switch identity.** Choose the organization you are working for or keep as individual use.

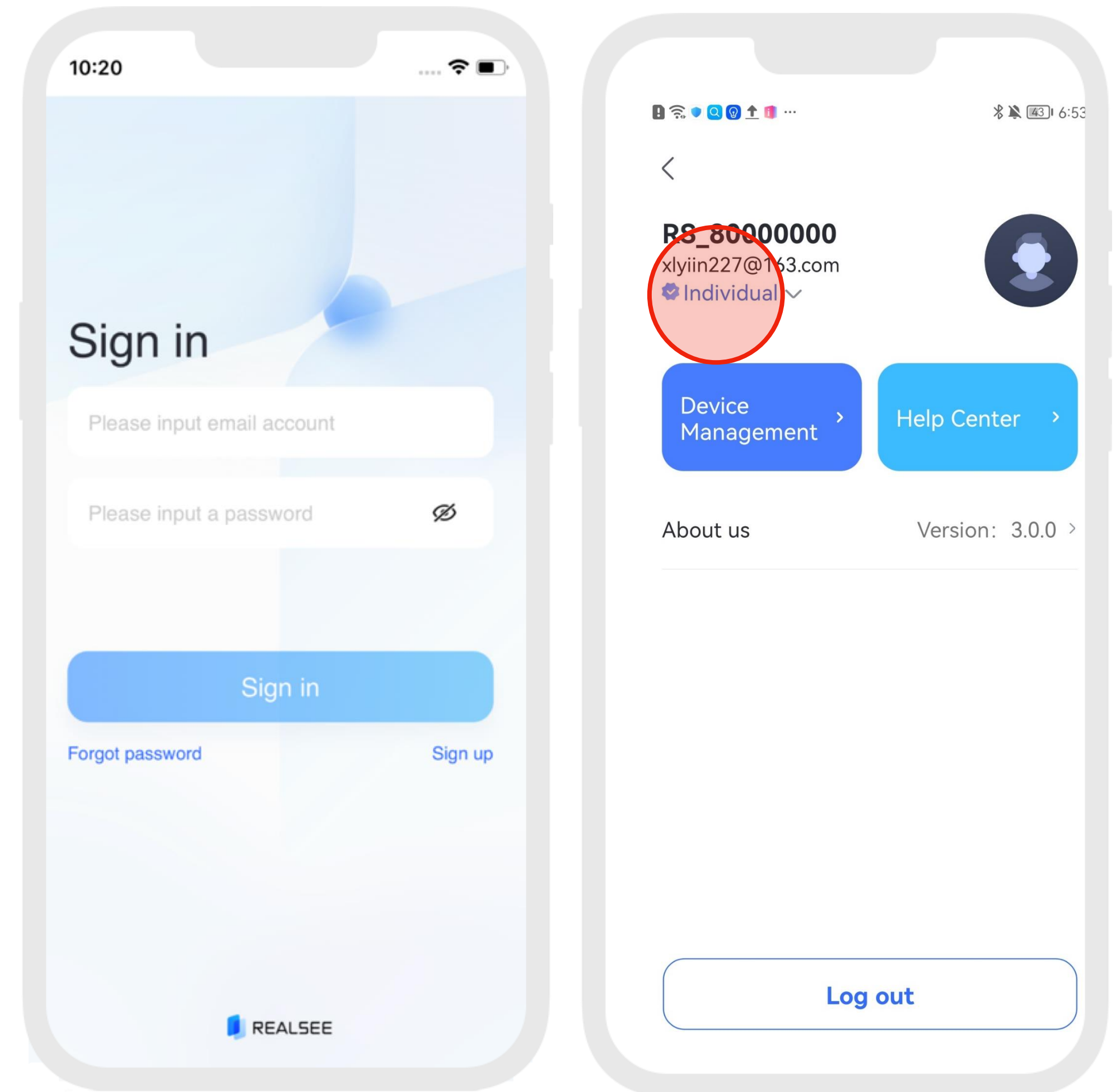

Scan the Space | Connection

- Connect your mobile phone with Realsee Gimbal
- Press the power button of Gimbal for 3 seconds.
- Make sure your phone's Bluetooth is enabled.
- Connect your phone to the Gimbal by tapping its serial number.

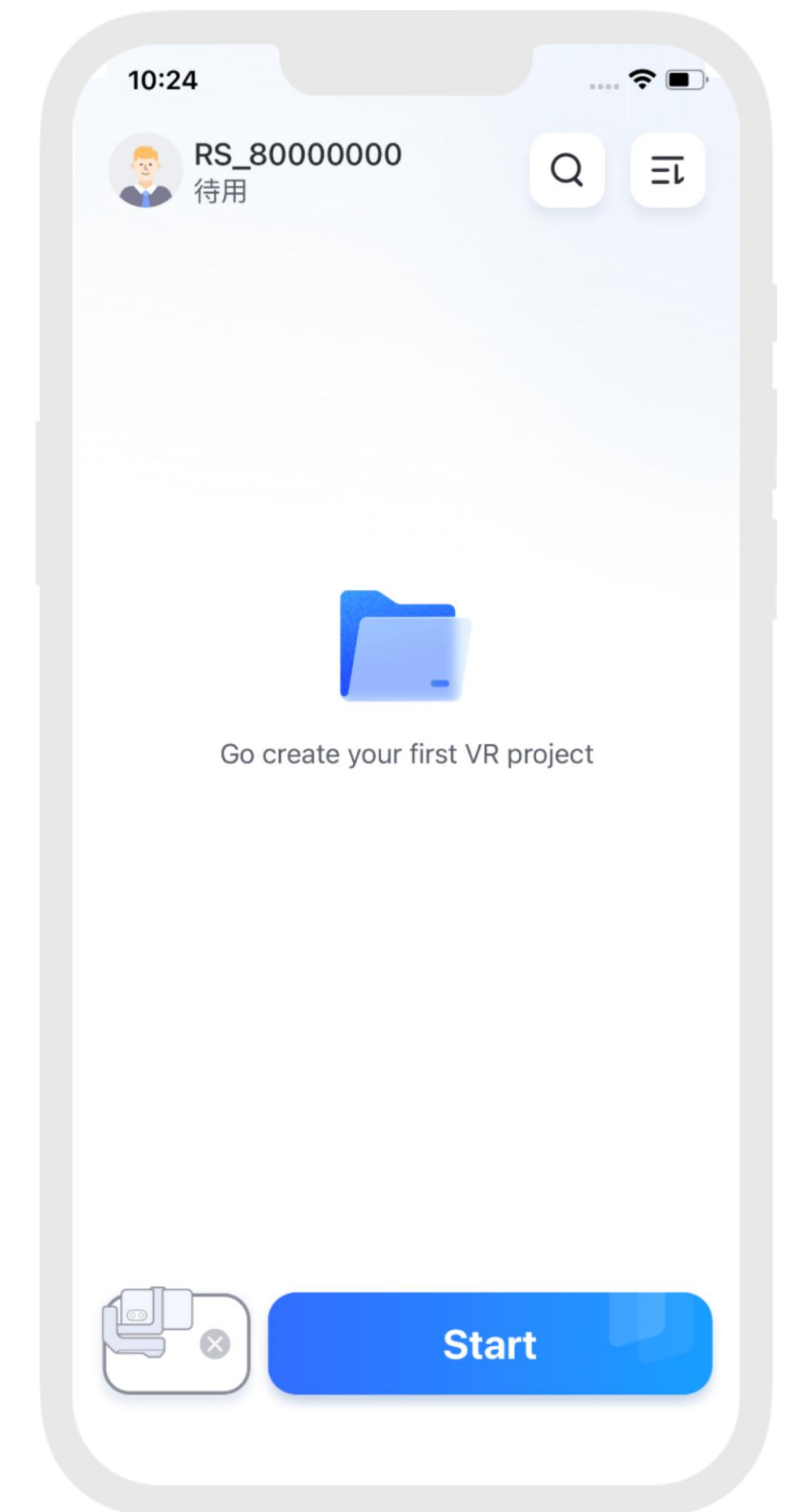
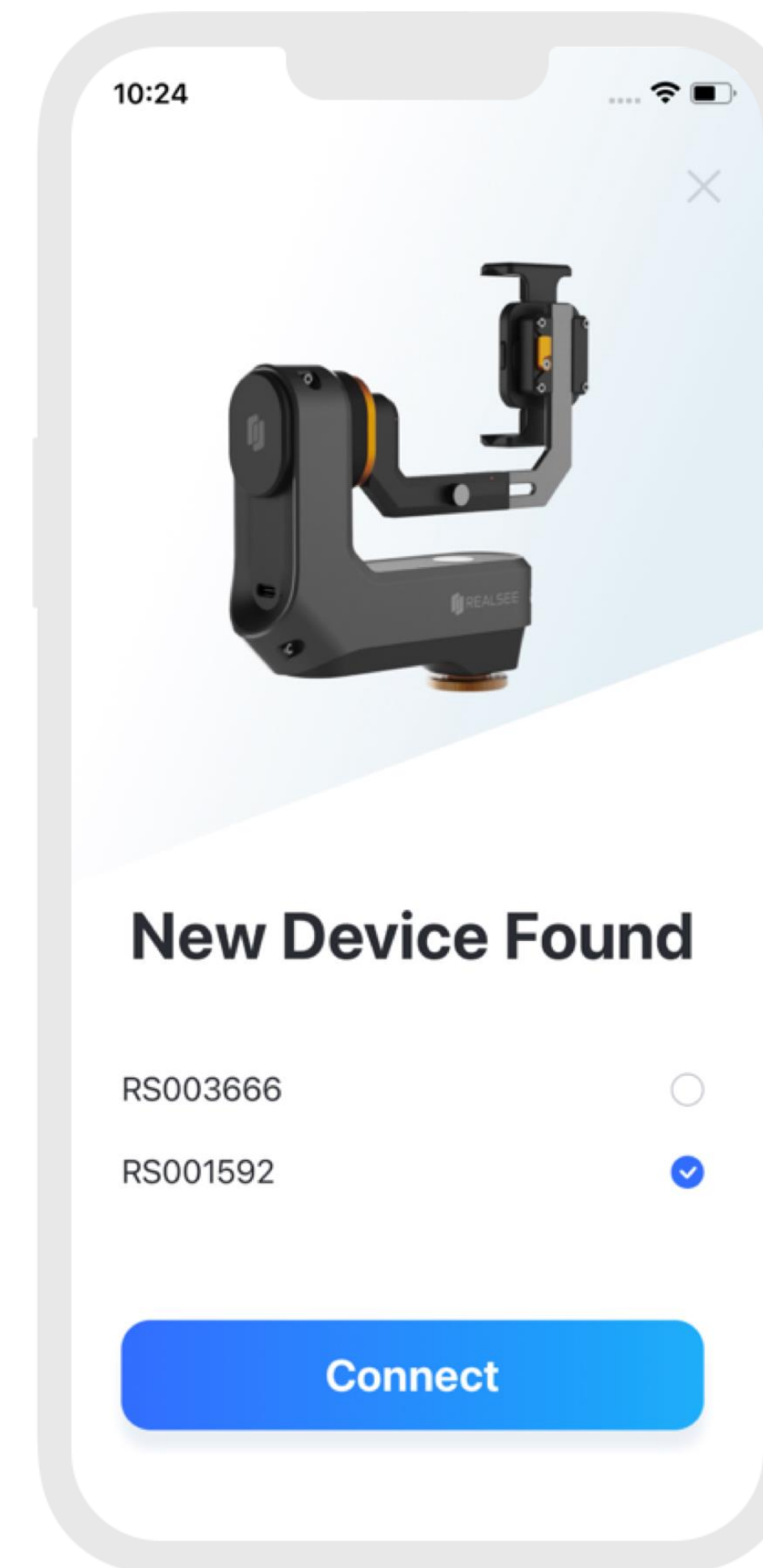

Scan the space | Capture

1、 Select floor

2、 Settings

3、 Capture

4、 Alignment

- Align Each scan
- Align Whole floor

5、 Upload

Tools ×

- Manual Splicing** >
Adjust the scan points to the correct positio...
- Aligning Floors** >
Manual Splicing

Scan Settings ×

- Countdown**
- Complete Scan**
Capture more floors and ceilings
- Wide-angle**
Wide-angle mode will be used to reduce rotation

Scan the Space | Scan settings

- Select the floor level
- If necessary, change settings by tapping the 'setting' button in the bottom right corner.
- You can set the [countdown](#) timer and scanning .
- The standard scan (default setting) is three-rings around. The ["Complete Scan"](#) allows you to capture more floors and ceilings.
- If your phone has wide-angle lens, you can turn the ["Wide angle"](#) on, to shorten the capture time.

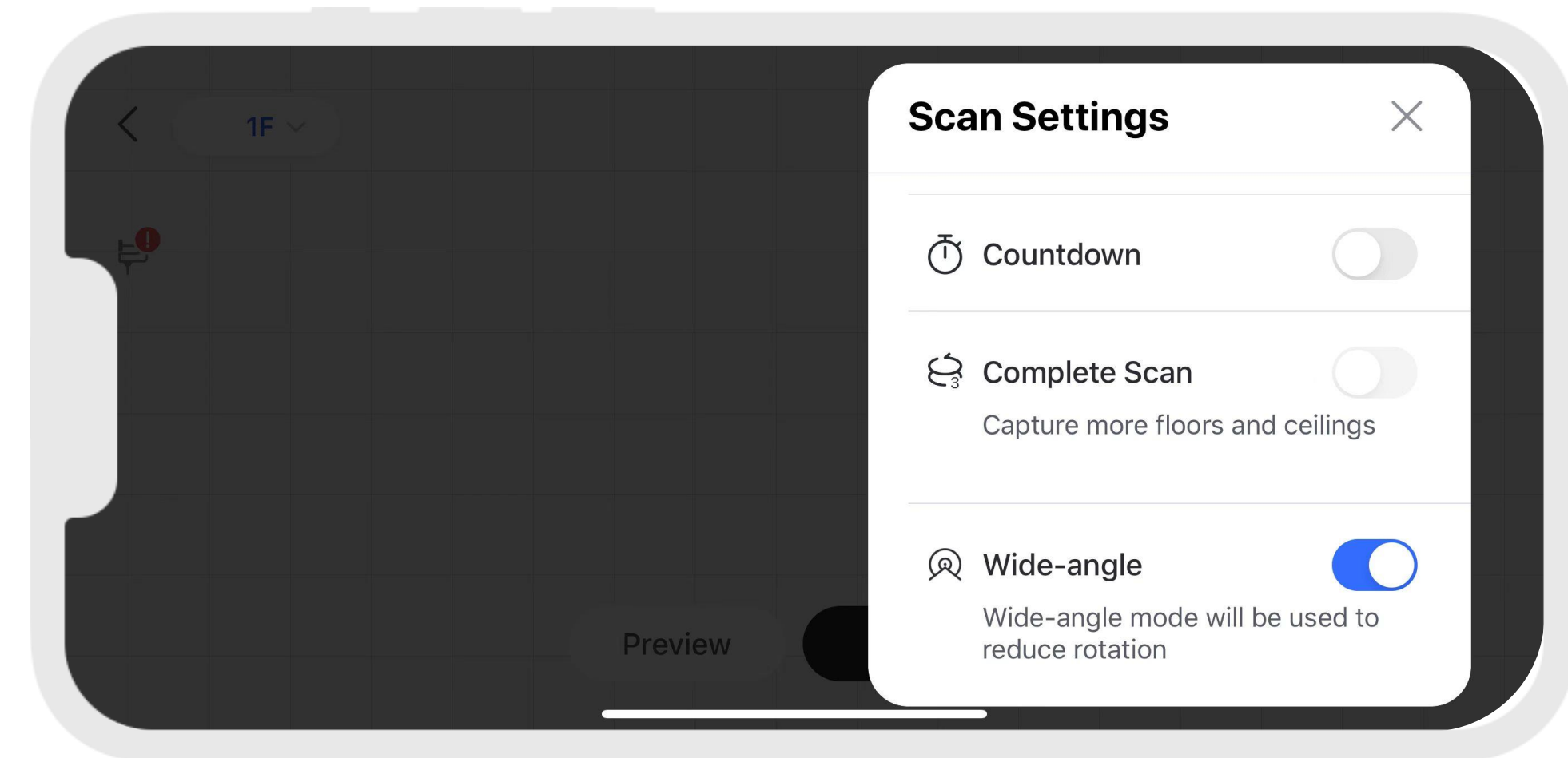
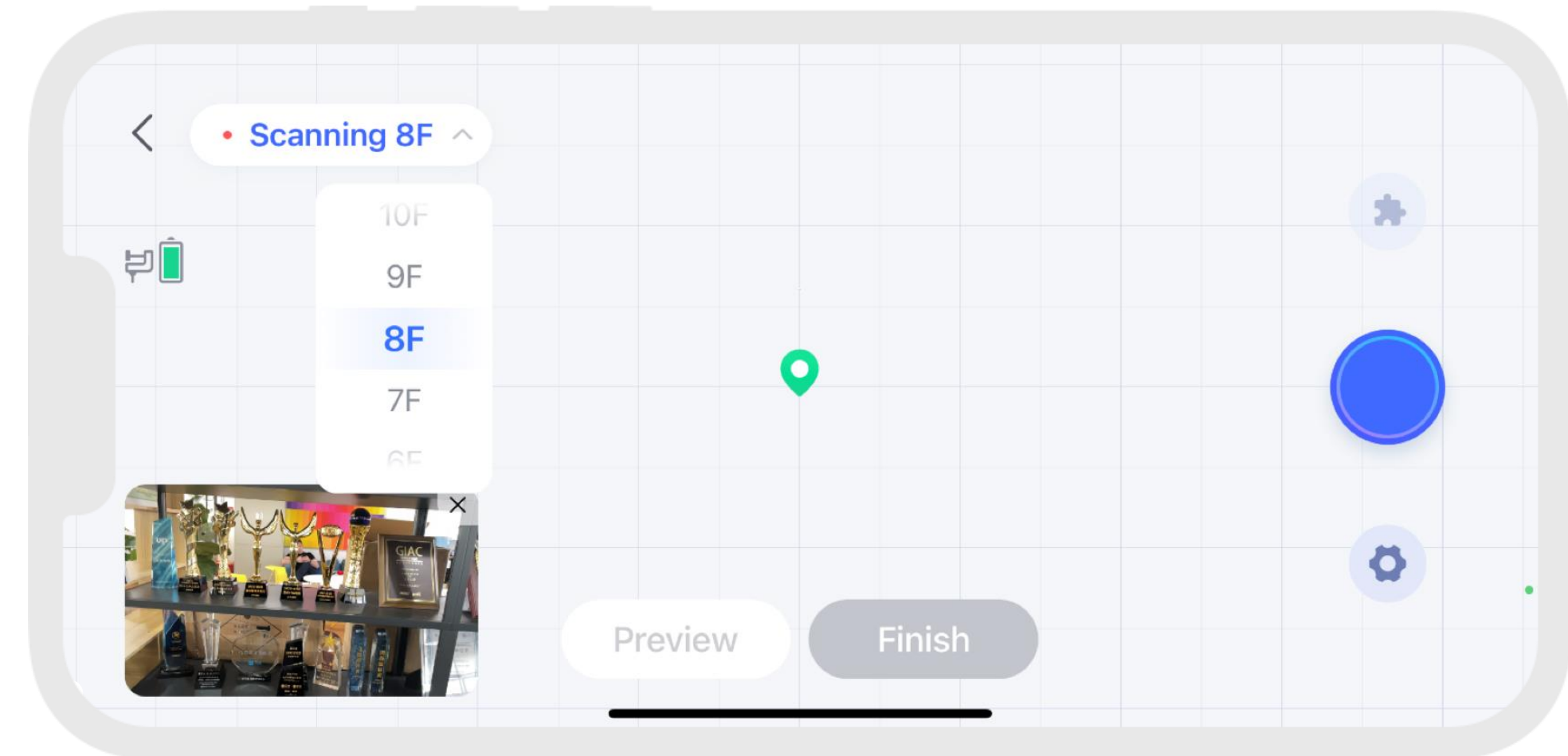

Scan the Space | Name your project and Generate VR

- After capturing all the points that you need, tap the 'Finish' button.
- Name your project and "Generate VR".

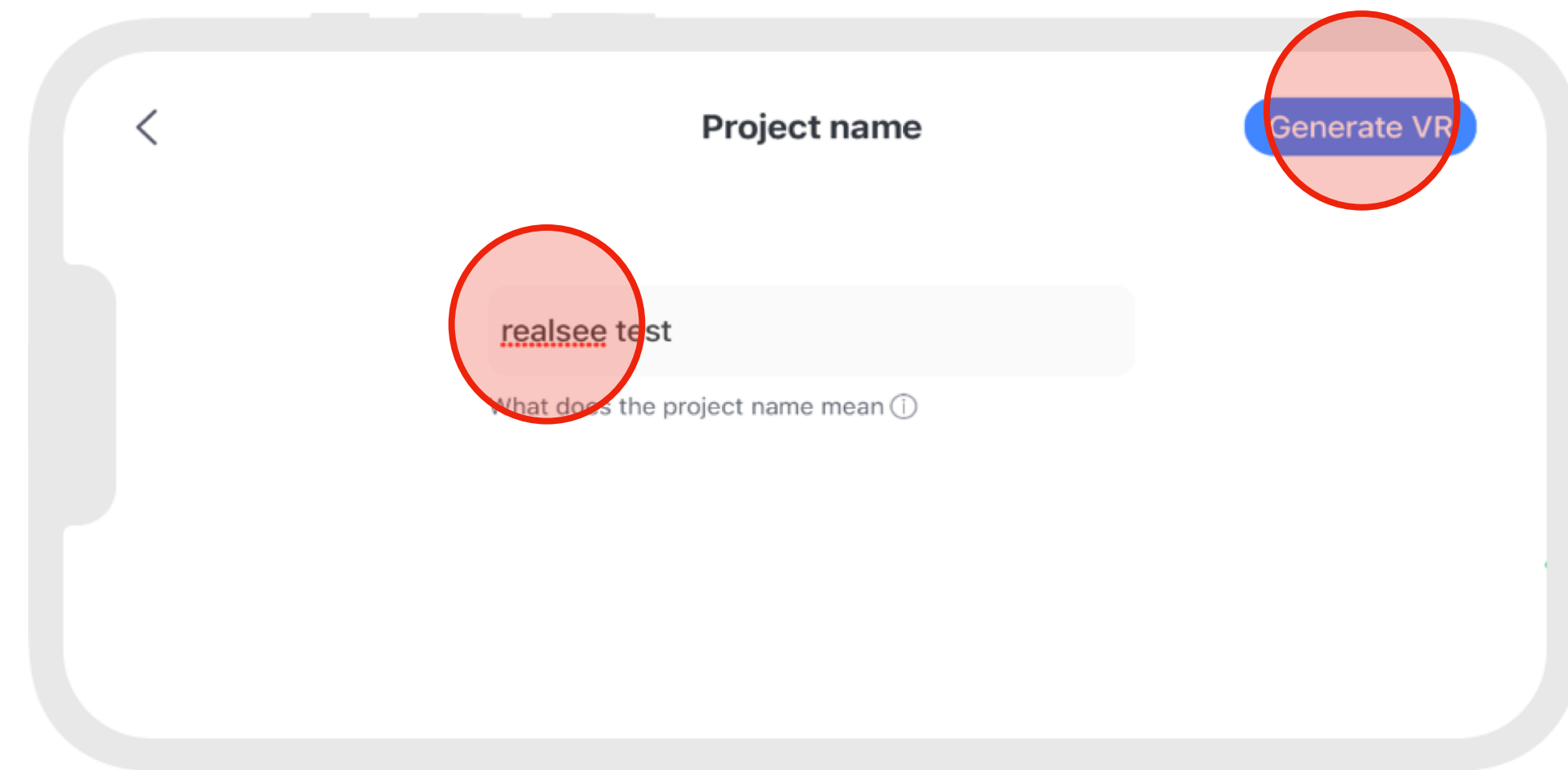
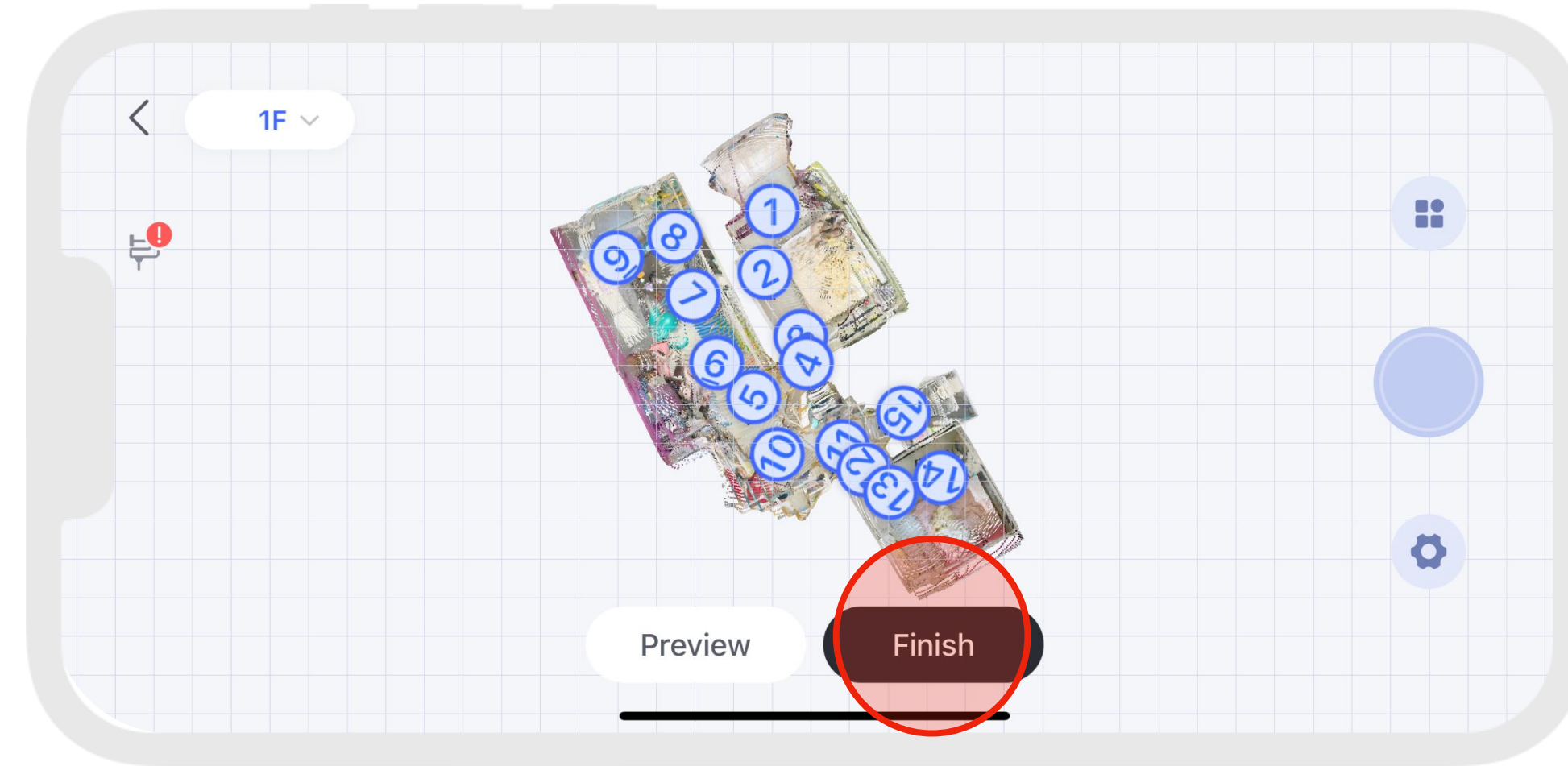

Scan the Space | Upload and Process

- You can view the project through both your mobile and PC devices after it is uploaded and processed.

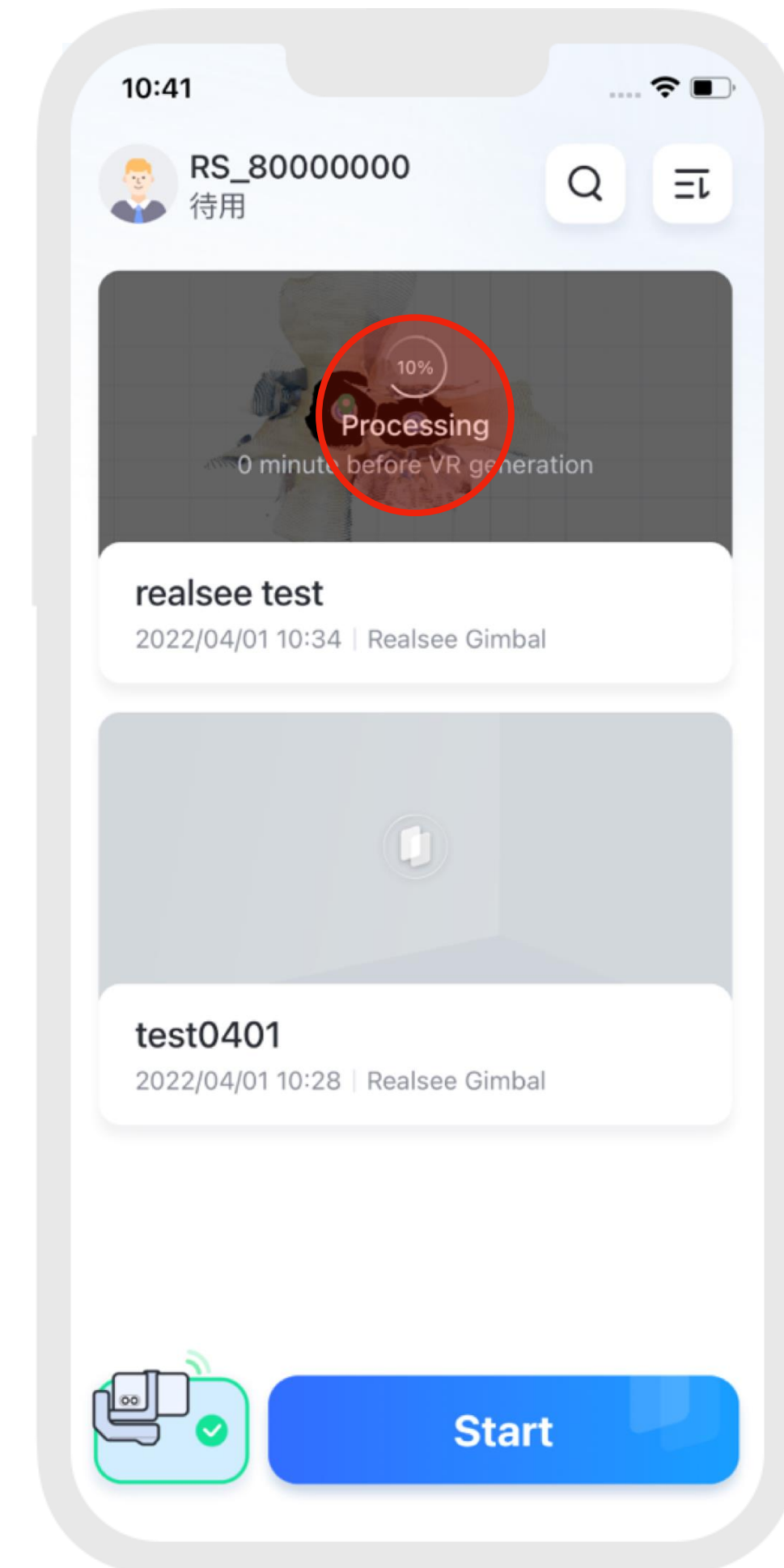
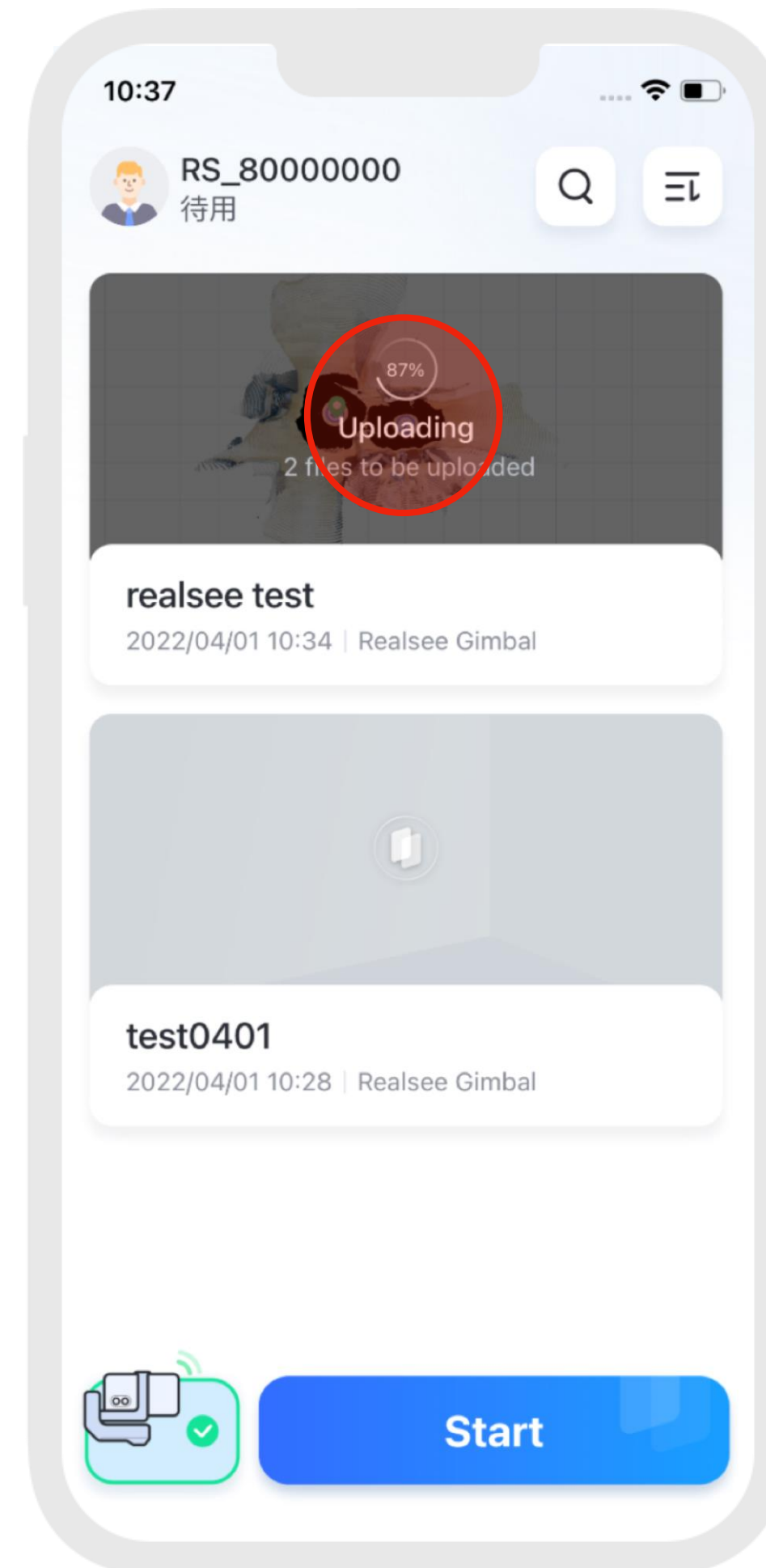

03.Workshop

- Publish
- Enrich Your VR tour
- Share

Workshop | Mobile-end Editing

- You can edit your project through your REALSEE VR APP.
- After choosing the project you are going to edit, you will enter the Mobile Workshop.

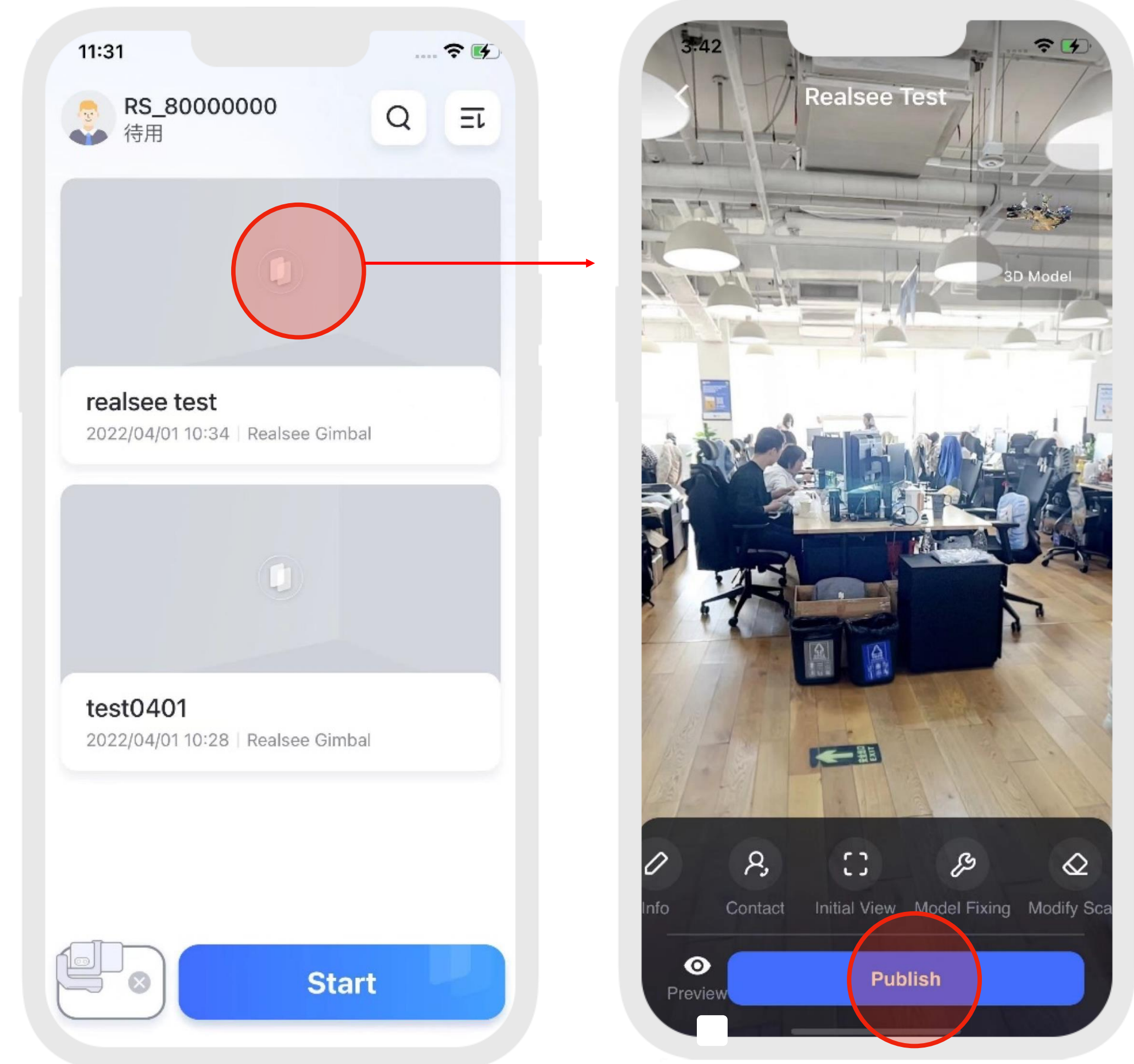

Workshop | Preview

- Click the 'preview' button, you can preview the panorama of your project.
- Also, click the '3D model' on the top right corner to view your 3D model.

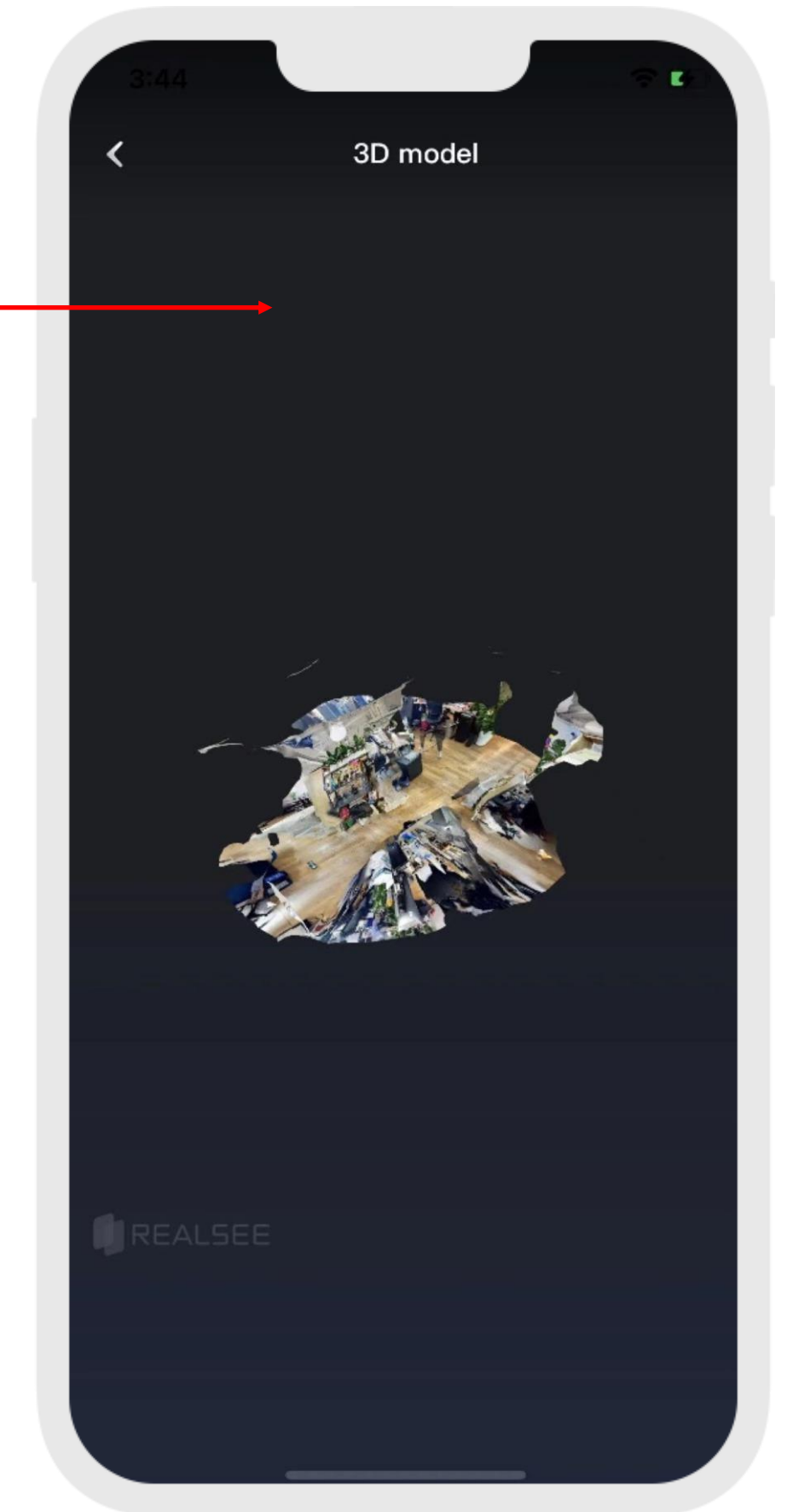
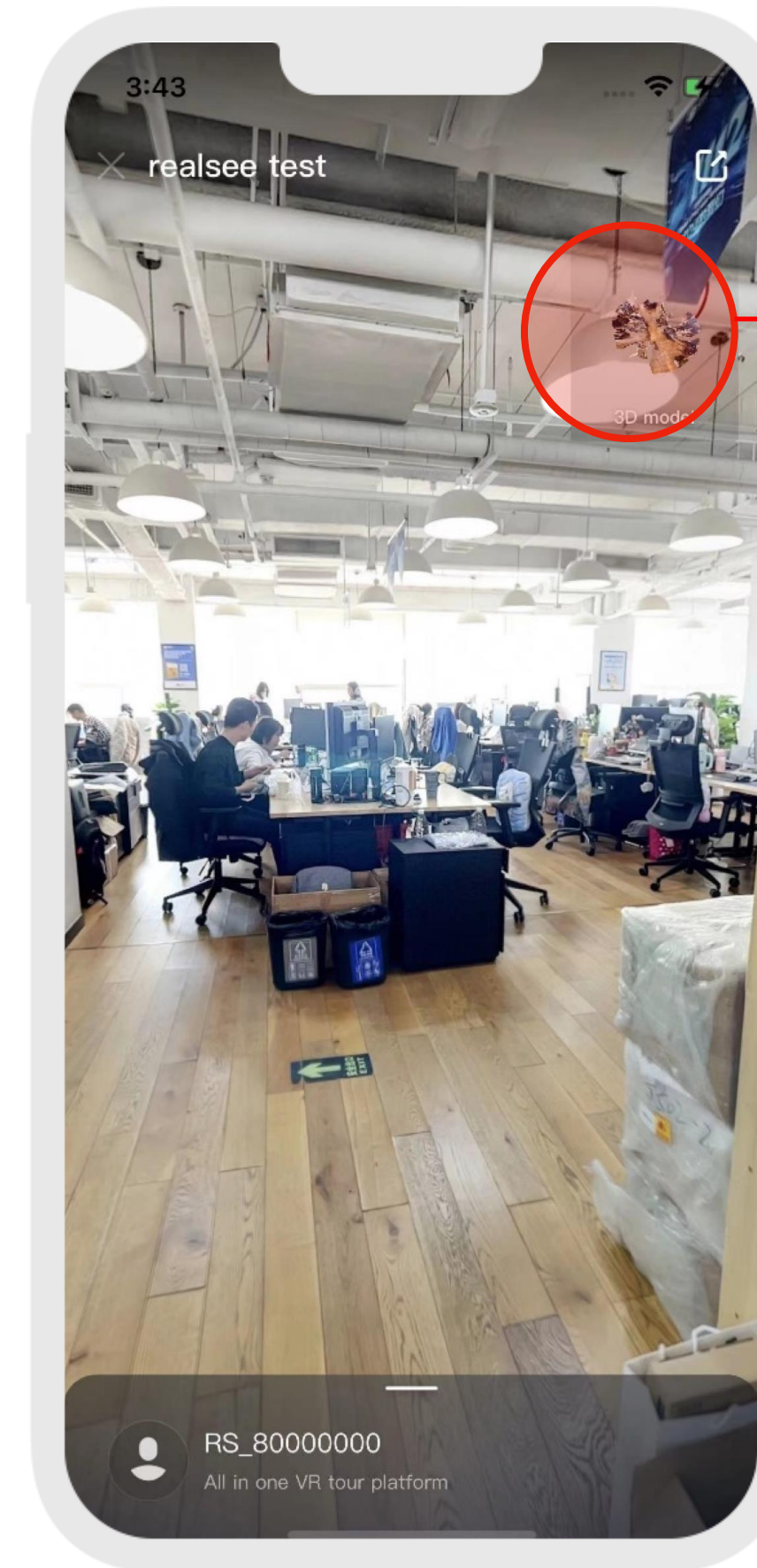
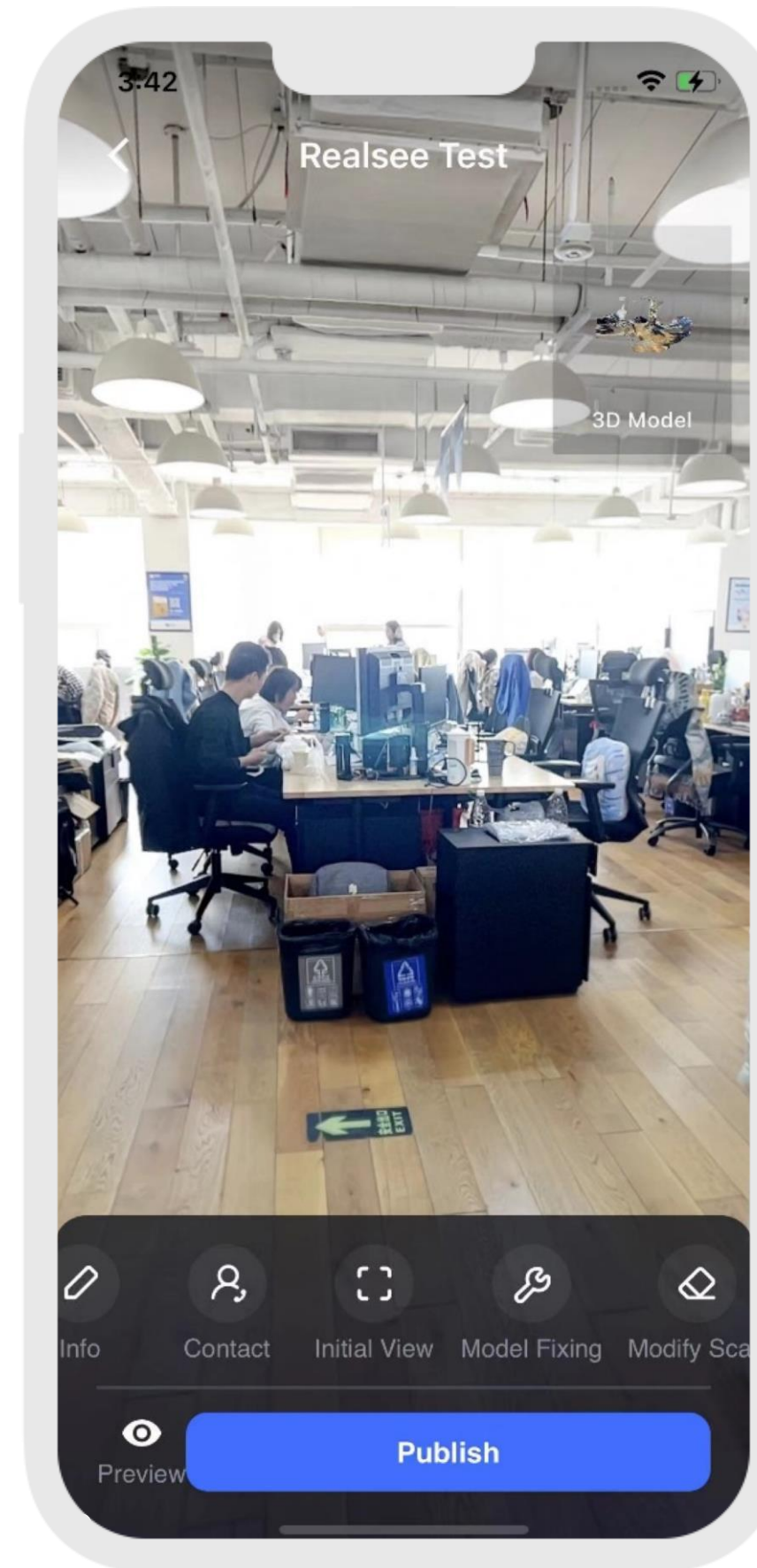

Workshop | Info & Contact details

- Add more detailed information for your project by tapping 'Info' or 'Contact' button. Remember that don't forget to save your settings.

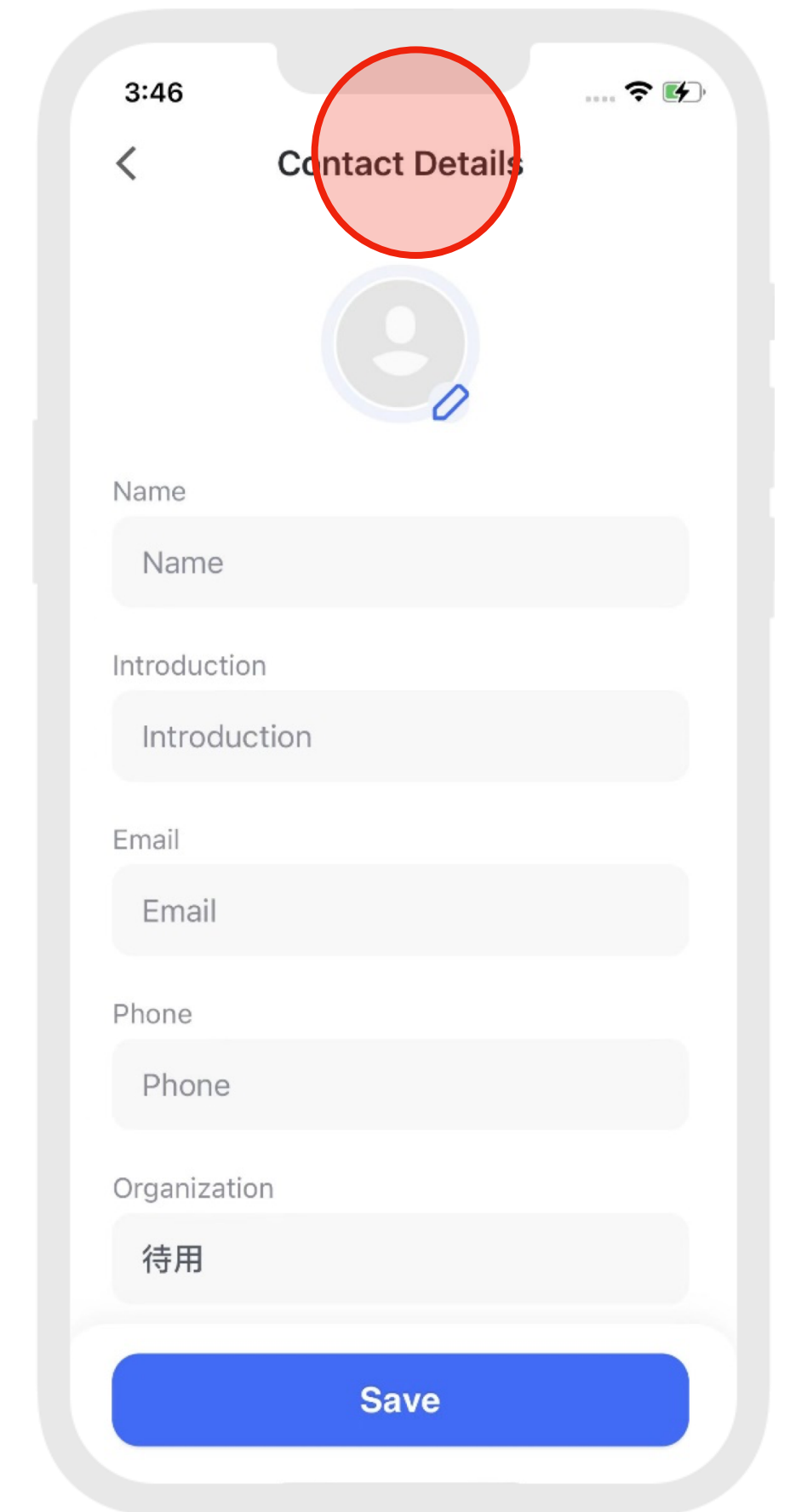
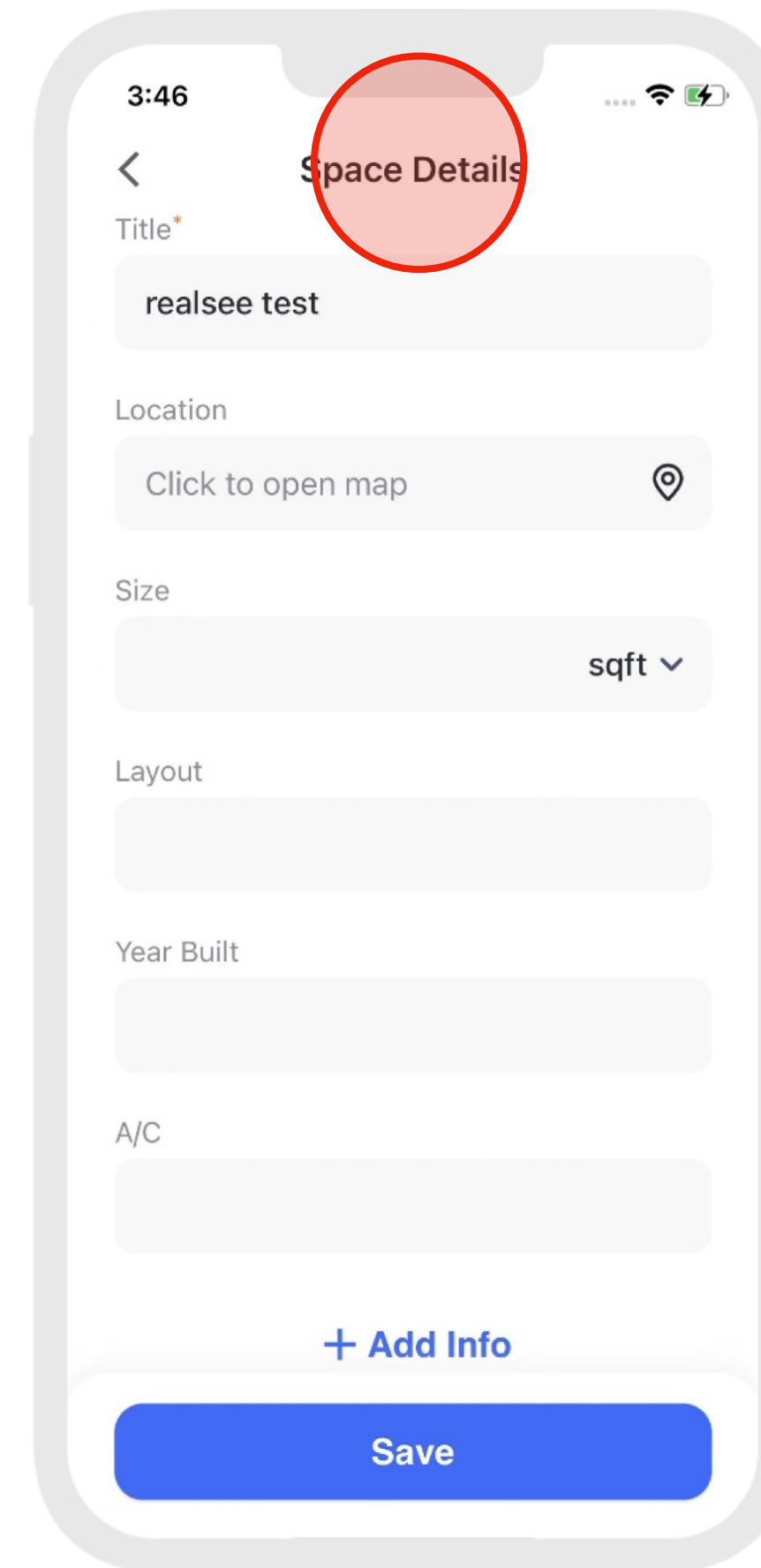
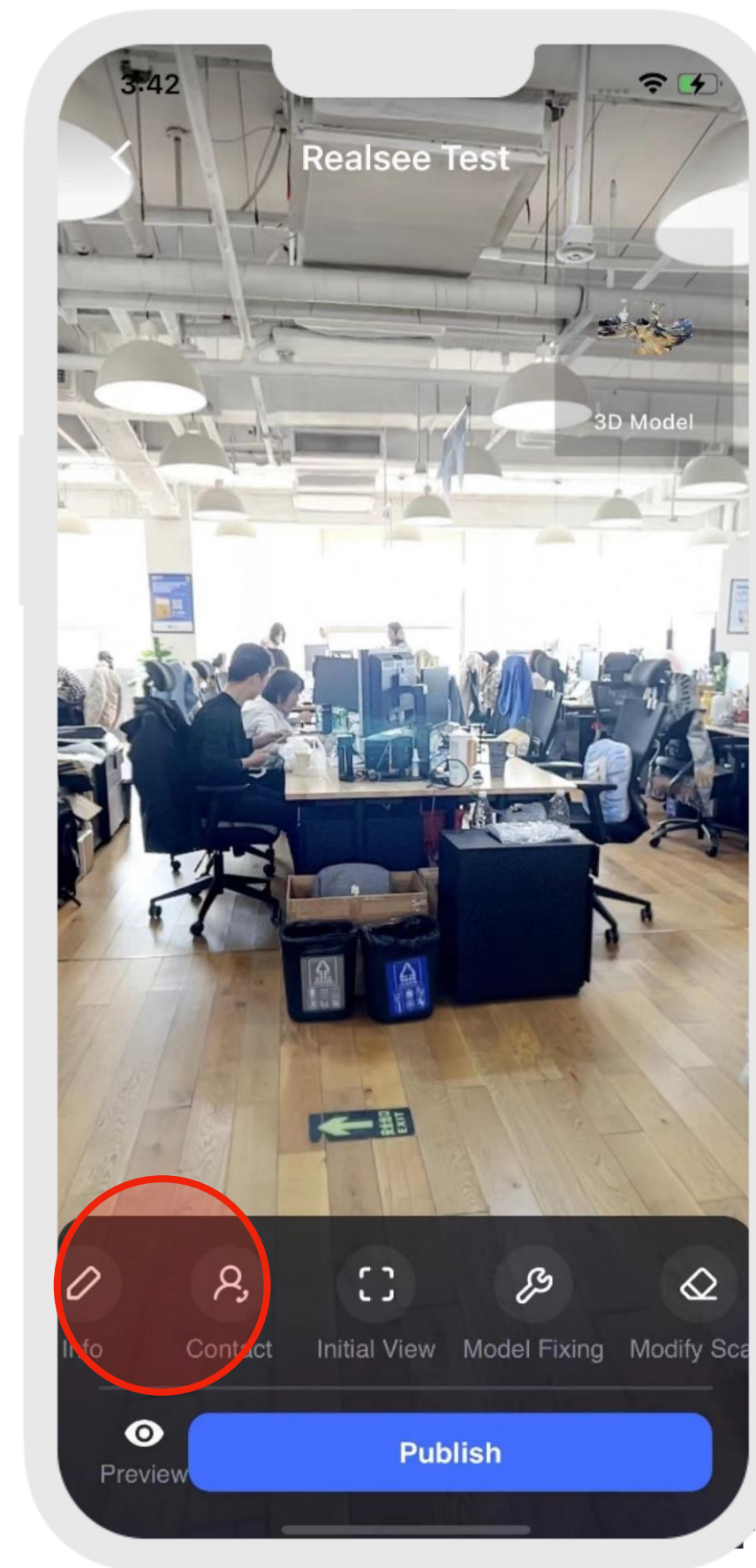

Workshop | Publish

- Click the blue 'publish' button to publish and share your completed project.

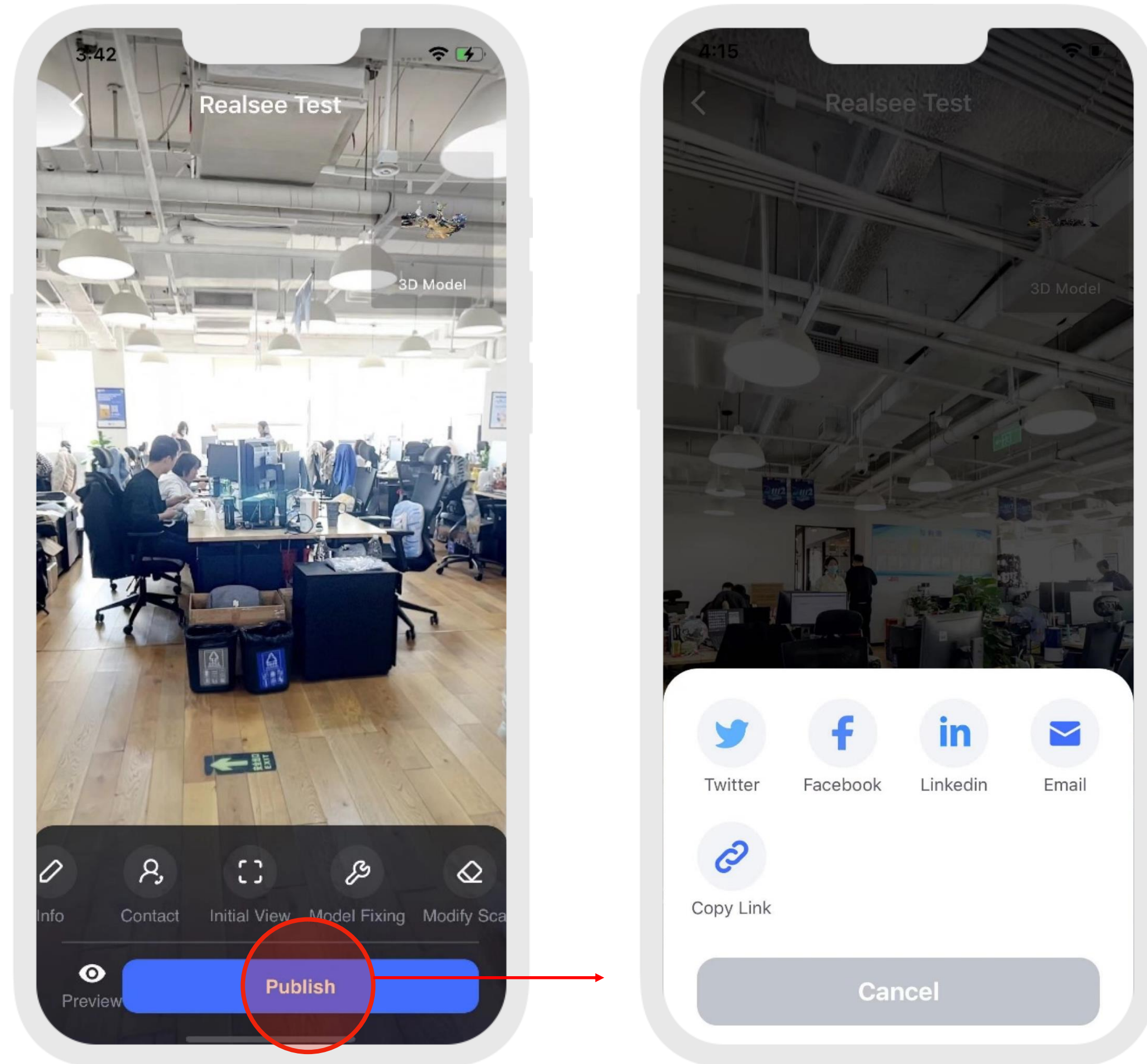

Workshop | Enrich Your VR tour

To manage all your tours in front of PC, you can access to: <https://new-workshop.realsee.jp/>

In the PC version workshop, you can:

- 1. Apply filters to your whole tour
- 2. Hide unwanted scan points
- 3. Blur unwanted items
- 4. Create a high-quality floorplan
- 5. Add guides to a tour so people can swiftly go to view that room

More details about PC version workshop, please refer to workshop guide.



Workshop

| Share the tour

You can get the URL of your virtual tour from app or workshop and share it to social media or embed it on any website or app.



04.Additional Tips

- Capture multi-floors
- Scan misaligned
- Fix the model
- Plan the scanning path--A more complex scenario

Tips

| Capture multi-floors

- There is no need to shoot staircases between levels for multilevel properties
- Use the button on the left of the App screen to simply move between levels.

Tips

Scan misaligned

- You only need to use this function if scan points appear to be misaligned – one scan point does not match with another like pieces in a jigsaw.

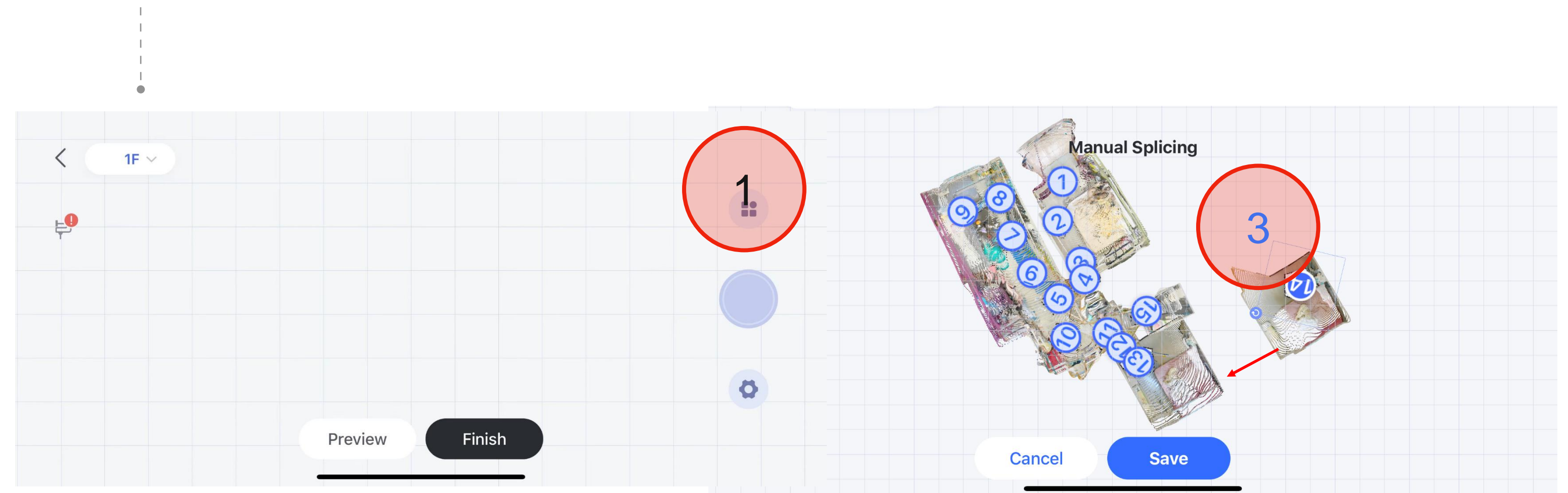

When a scan is offset, you need to:

- Select the misaligned scan point —Manual Align— Check mark-- Drag and/or Rotate it to the correct location.

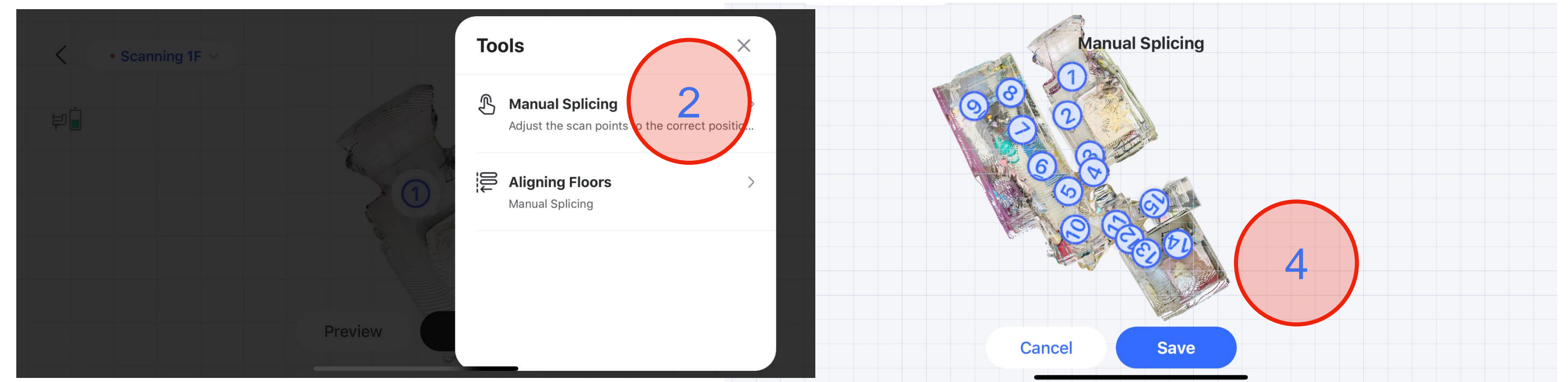

Tips

Fix the model

For unpublished tours

When the scan points on the phone are perfectly located but the tour generated has errors, such as two rooms are stitched into one room, then “Model Fixing” is a smart button to rerun the project and fix the error.

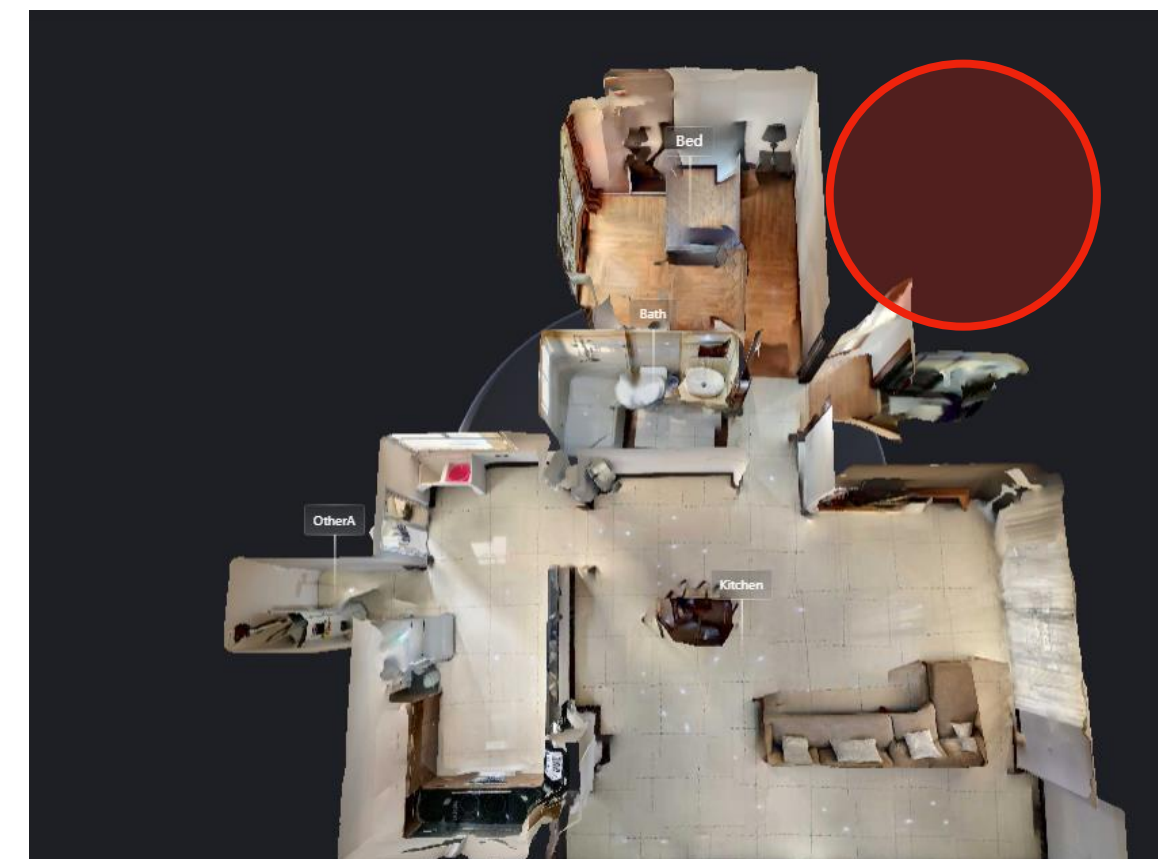
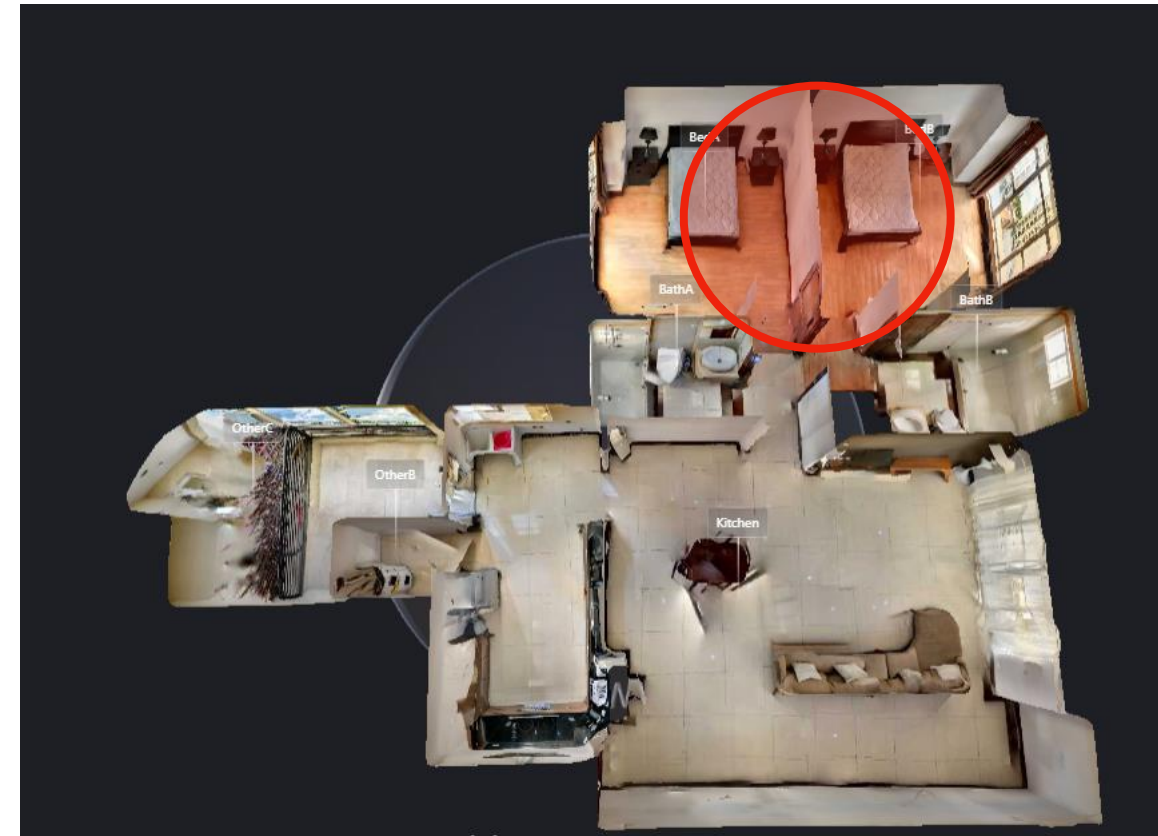

Example: two similar rooms are stitched into one

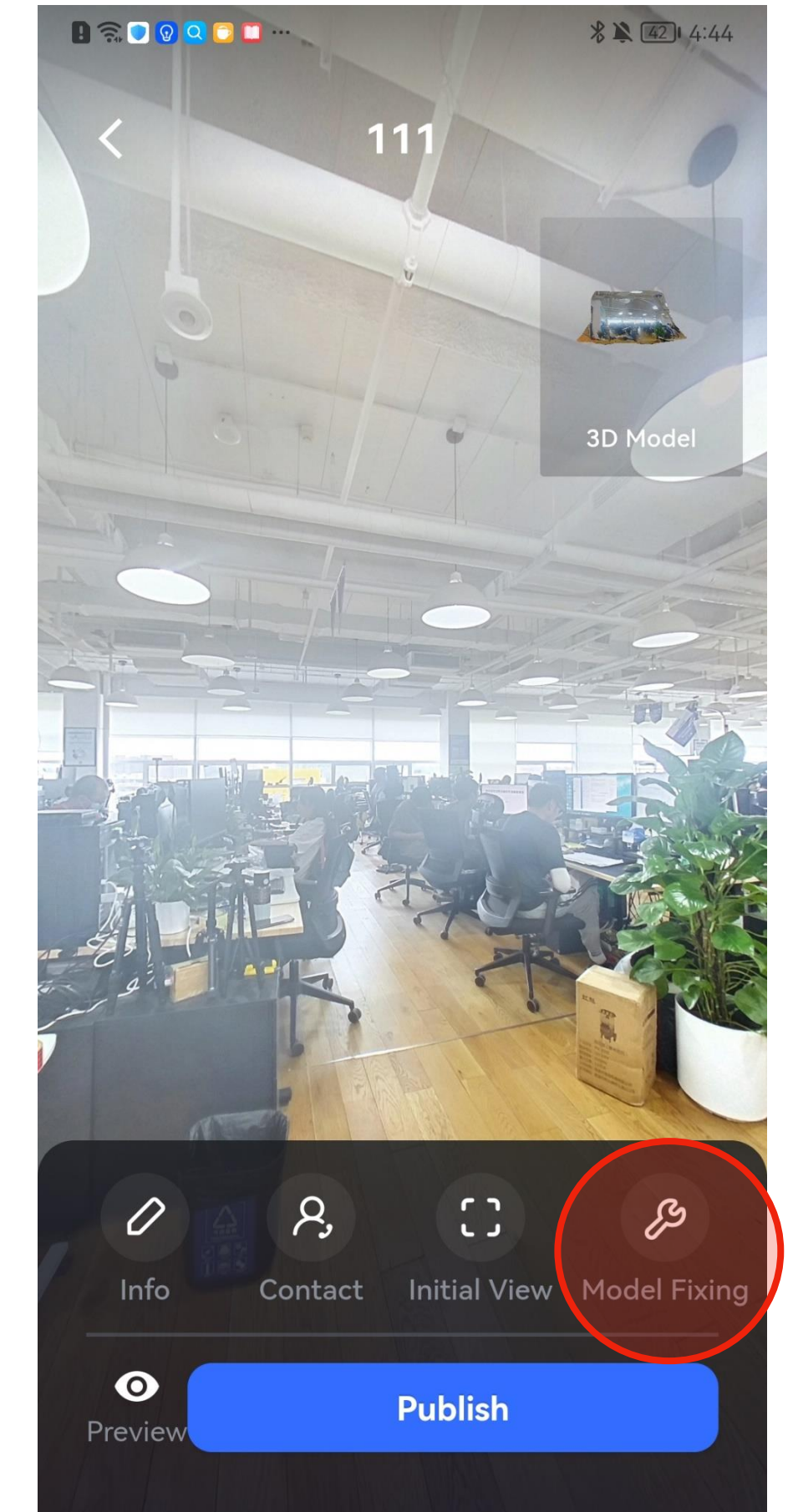

Additional Tips | Plan the scanning path--A more complex scenario

- Make sure that all the space to be scanned is accessible
- For narrow and long aisles, you can shorten the distance between scan points. See Point [19,20,21,27,28](#); and Point [43,44,45,46,47](#)
- Scan outdoor or balcony at last
- In narrow areas where the door is set at [45-degree angle](#), make sure there is clear line of sight. Scan before and behind the door. See Point [14, 15, 16](#)
- For empty rooms, [take 1 or 2 points](#).
- For rooms with furnishings that may draw interest, take scans near the point of interest to better display the features.

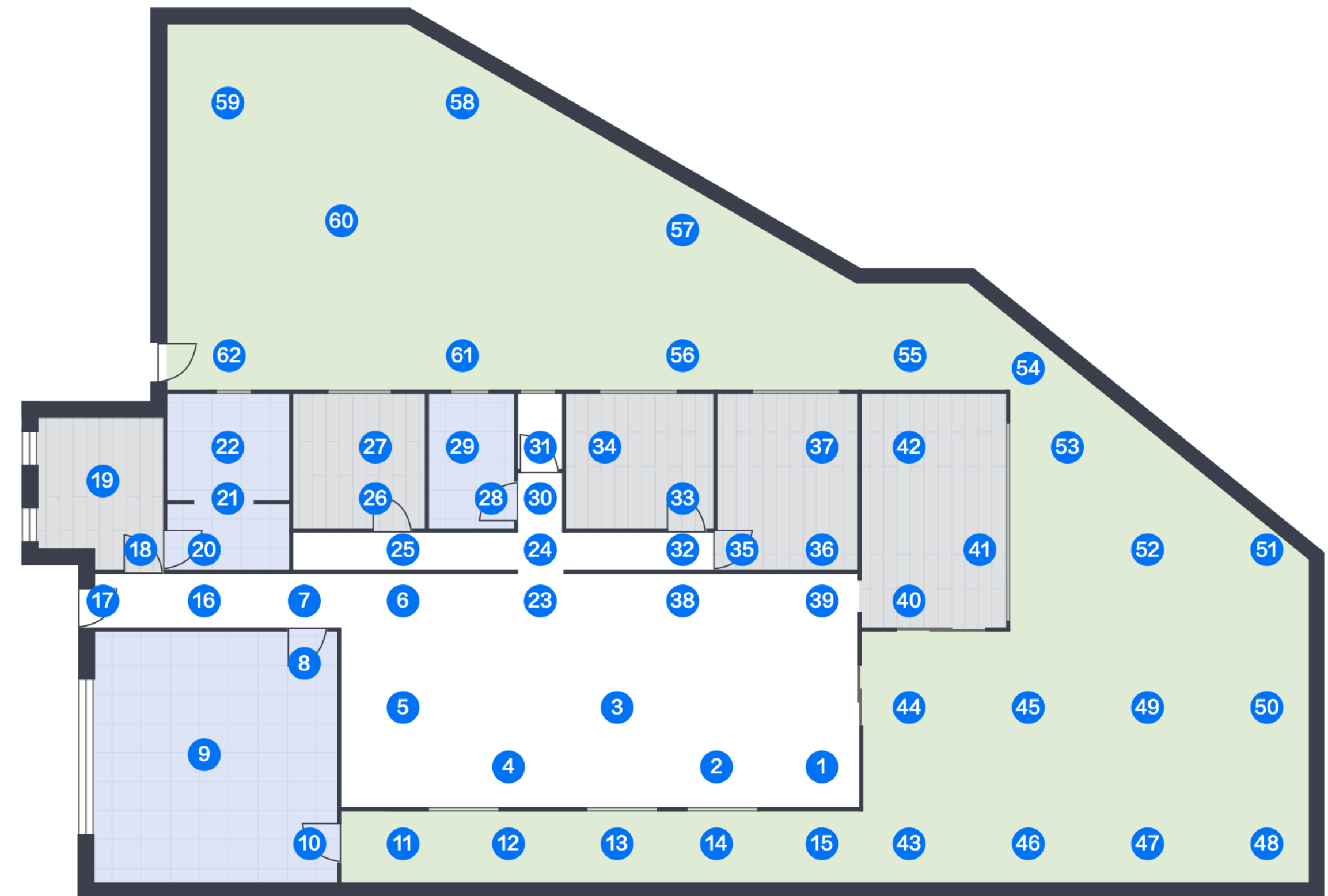

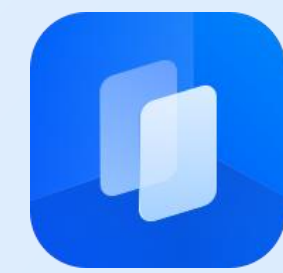

Thanks